



Skate Parks

Catalogue

Forhandler Norge ArC



SKATEPARK



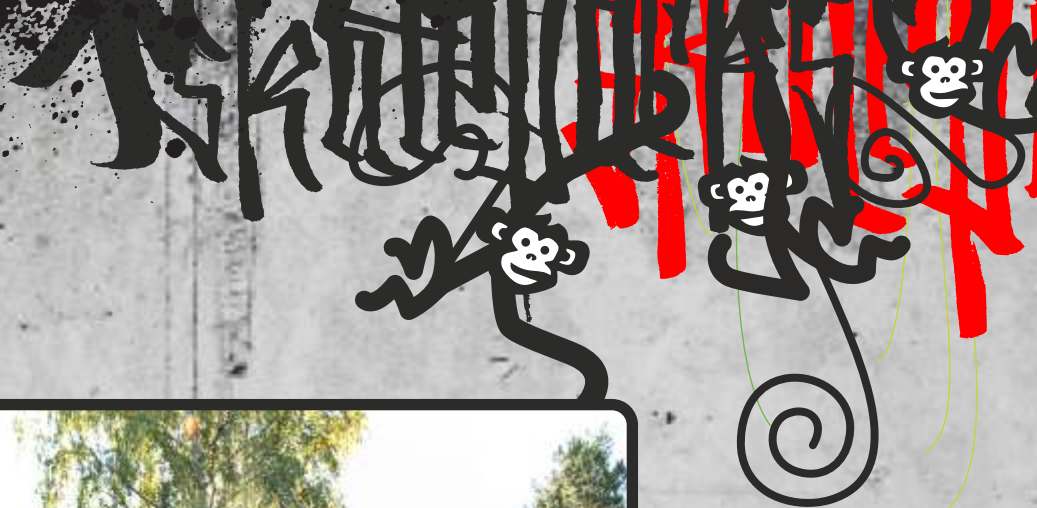

TiptiTap skateparks

With over 15 years of experience and over 200 different solutions - TiptiTap is the right choice for you!

Our skateparks have been developed in partnership with professional riders who know how to challenge their BMX, skateboards, scooters, inliners and more. All our skatepark elements have been manufactured in accordance with the European safety standard EN 14974:2006/A1:2010 and certified by TÜV SÜD GmbH.

The product choice includes both steel and wooden frame elements, either with phenol coated waterproof plywood or "Skatelite" surface - all high quality and weather resistant. Our skateparks evolve in line with the requests and needs of our clients and we try to fulfil the wishes of even the most demanding customers. Creativity and flexibility are always a priority for us.

Separate skatepark constructions

This is the perfect solution, if you wish to add structures to the existing park or design your own layout. Our separate constructions are available in several configurations: Base, Base+ and Steel PRO, but custom made solutions are also possible.

The constructions are designed to be placed on any flat surface like concrete or asphalt. If you can't find the desired ramp from the list, simply contact us to get it custom made.



Plaza skateparks.

Plaza type skateparks is a new trend. They replicate elements of urban architecture and movables. These skateparks are focused on sliding and jumping, easy to use also by non-professionals. The elements are small but offer a lot of fun and can be used by different vehicles.

Plaza series skateparks are made of high-quality waterproof plywood.

Constructions are easy to assemble.

Dots under the icons indicate the usability of a skatepark for different type of riders:

 ooo	 ooo	 ooo	 ooo	nearly limitless very good limited
 oo	 oo	 oo	 oo	
 o	 o	 o	 o	

SKATEPARK

Base / Base +

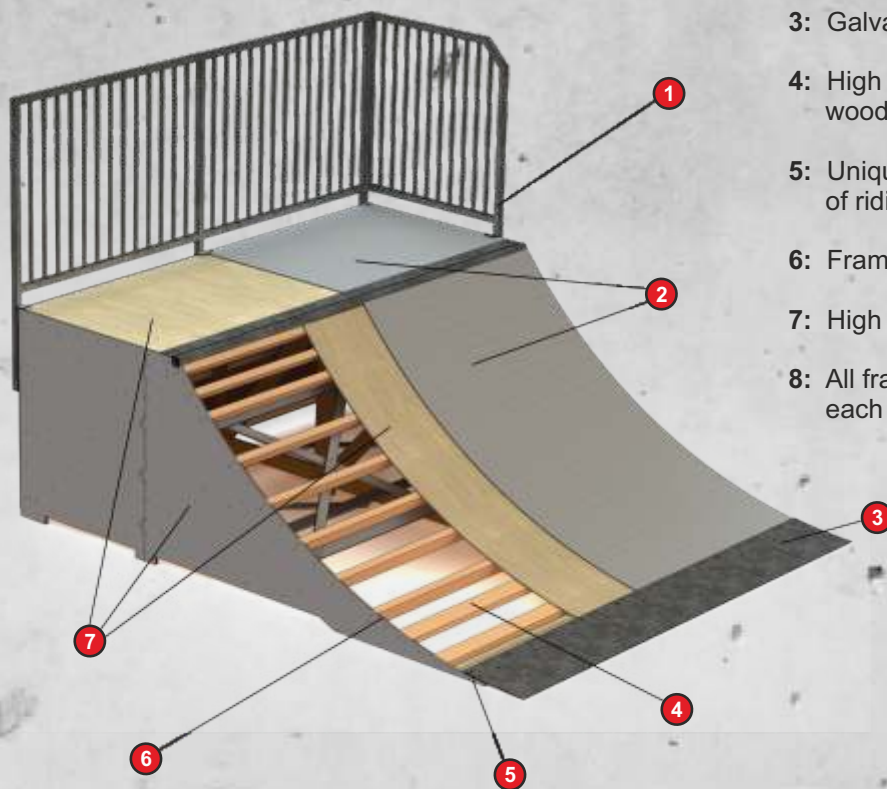

1: Hot galvanized steel safety railing.

2: Top layer:
Waterproof plywood with anti-slip
phenol film (Base) or
Professional riding surface
"Skatelite" (Base+)

3: Galvanized steel sheet.

4: High quality dried and impregnated
wooden beams.

5: Unique joint system for the connection
of riding surface and steel sheet.

6: Frame made from waterproof plywood.

7: High quality waterproof plywood.

8: All frame details are connected to
each other by a puzzle-type connection.

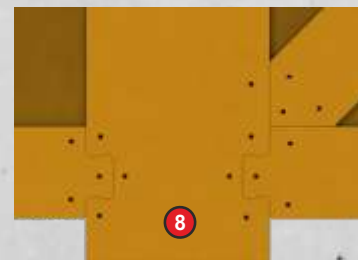

Steel PRO

(maintenance free)

- 1: Top layer:
Professional riding surface "Skatelite".
- 2: Bottom layer: composite material.
- 3: Frame and all safety railings made from
hot galvanized steel.
- 4: Back and sides covered with composite
material or plastic.
- 5: Galvanized steel sheet.



SKATEPARK



B 100

Park area: 176m²

Riding surface: 40m²

Dimensions: 22x8x1m

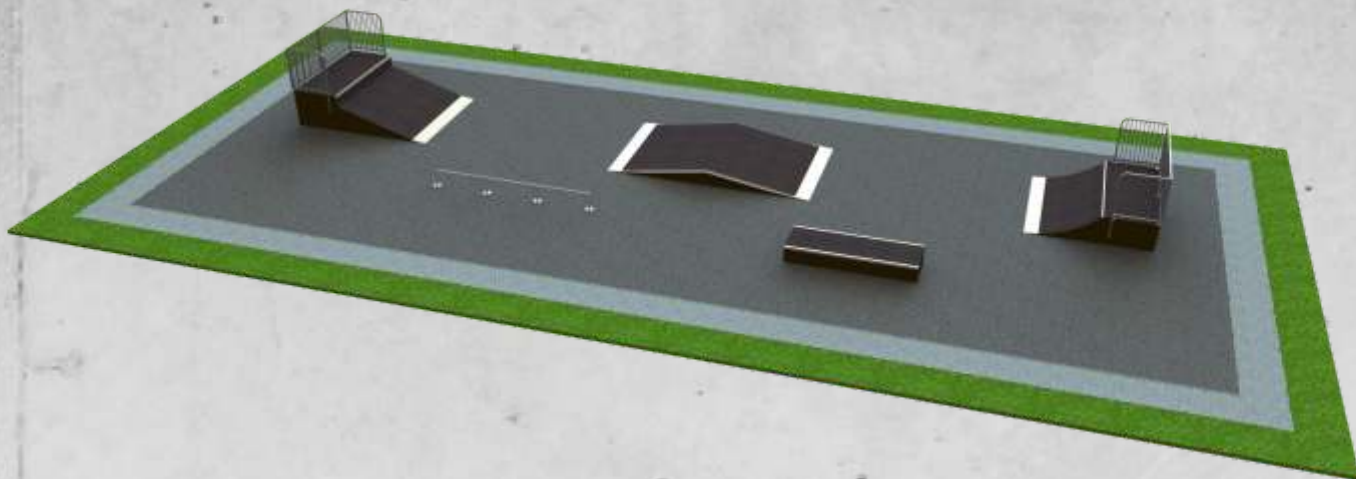



B 103

Park area: 300m²

Riding surface: 39m²

Dimensions: 10x30x1.5m

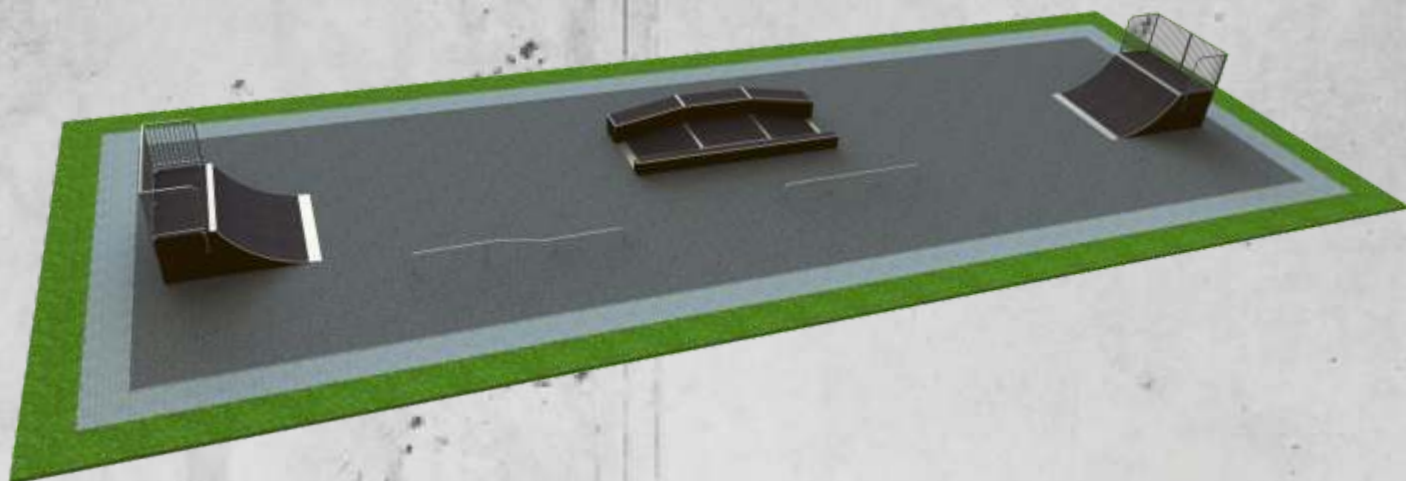

SKATEPARK



oo



o



o



oo

B 105

Park area: 250m²

Riding surface: 46m²

Dimensions: 10x25x1m

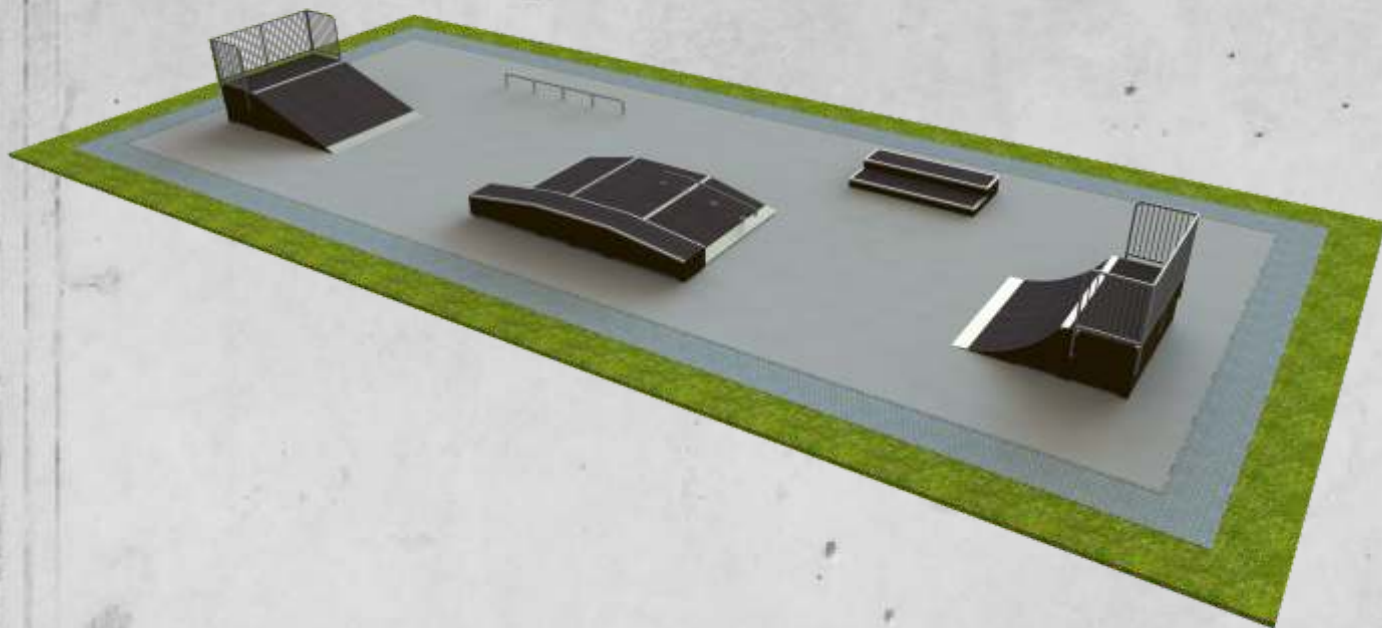



B 108

Park area: 308m²
Riding surface: 48m²
Dimensions: 28x11x1.2m

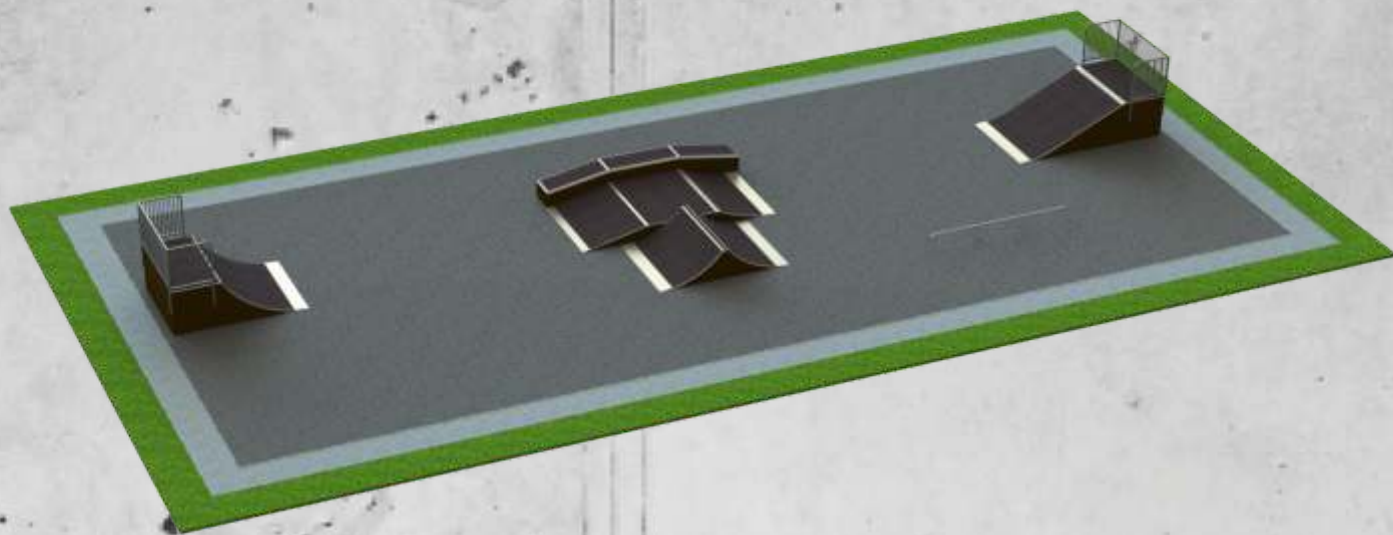

SKATEPARK



ooo



o



oo



ooo

B 110

Park area: 150m²

Riding surface: 64m²

Dimensions: 25x6x1.5m

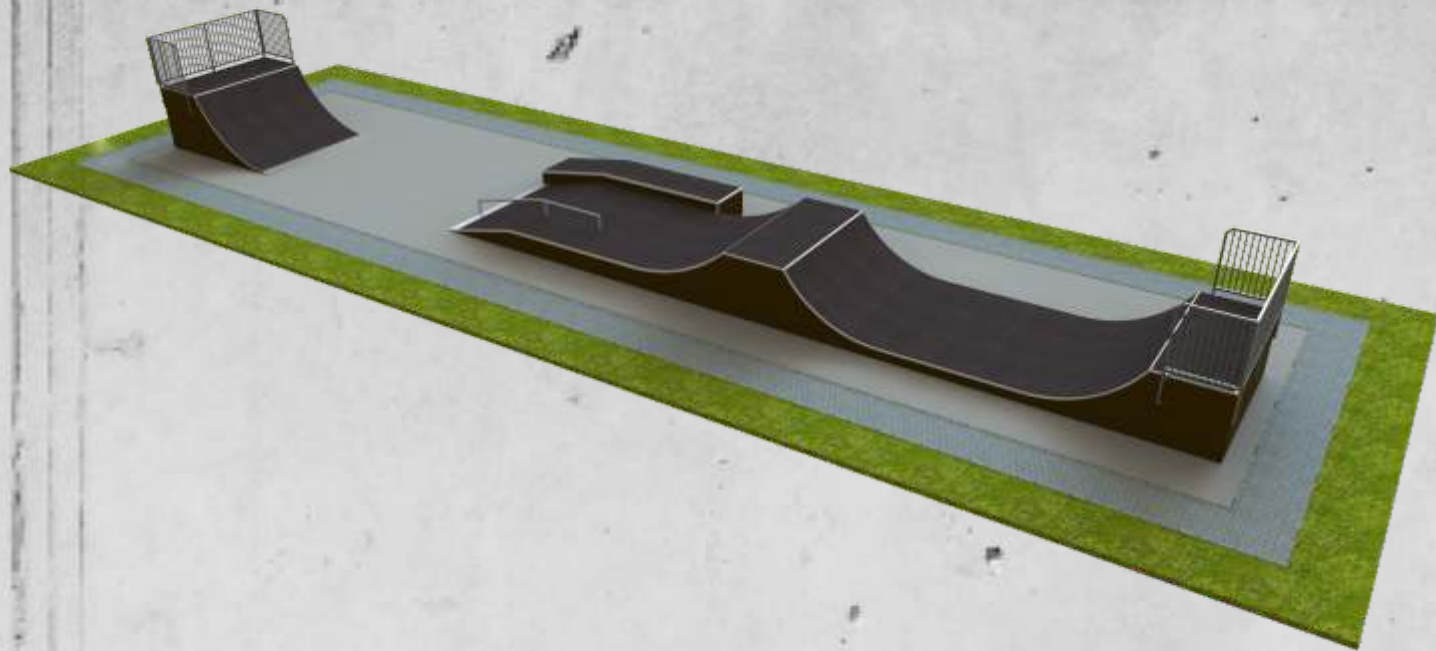



B 111

Park area: 450m²
Riding surface: 69m²
Dimensions: 30x15x1.5m

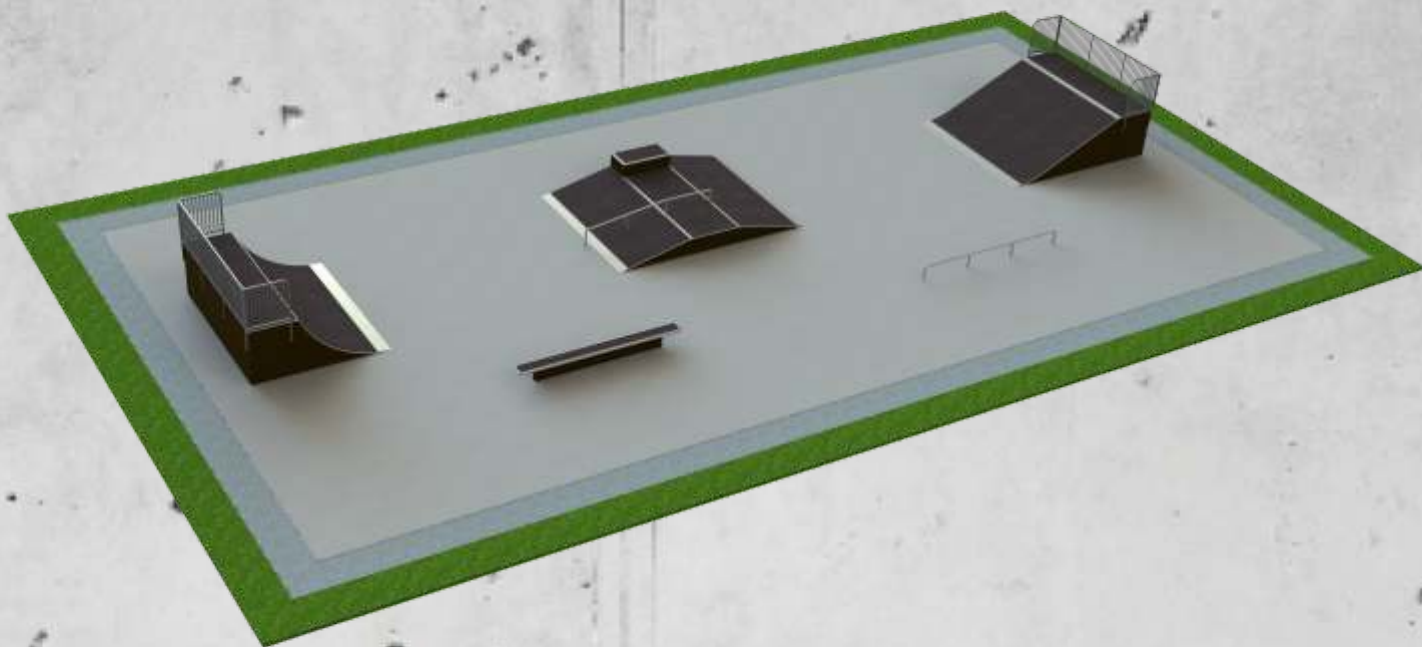

SKATEPARK



oo



oo



o



ooo

B 112

Park area: 600m²

Riding surface: 80m²

Dimensions: 30x20x1.5m

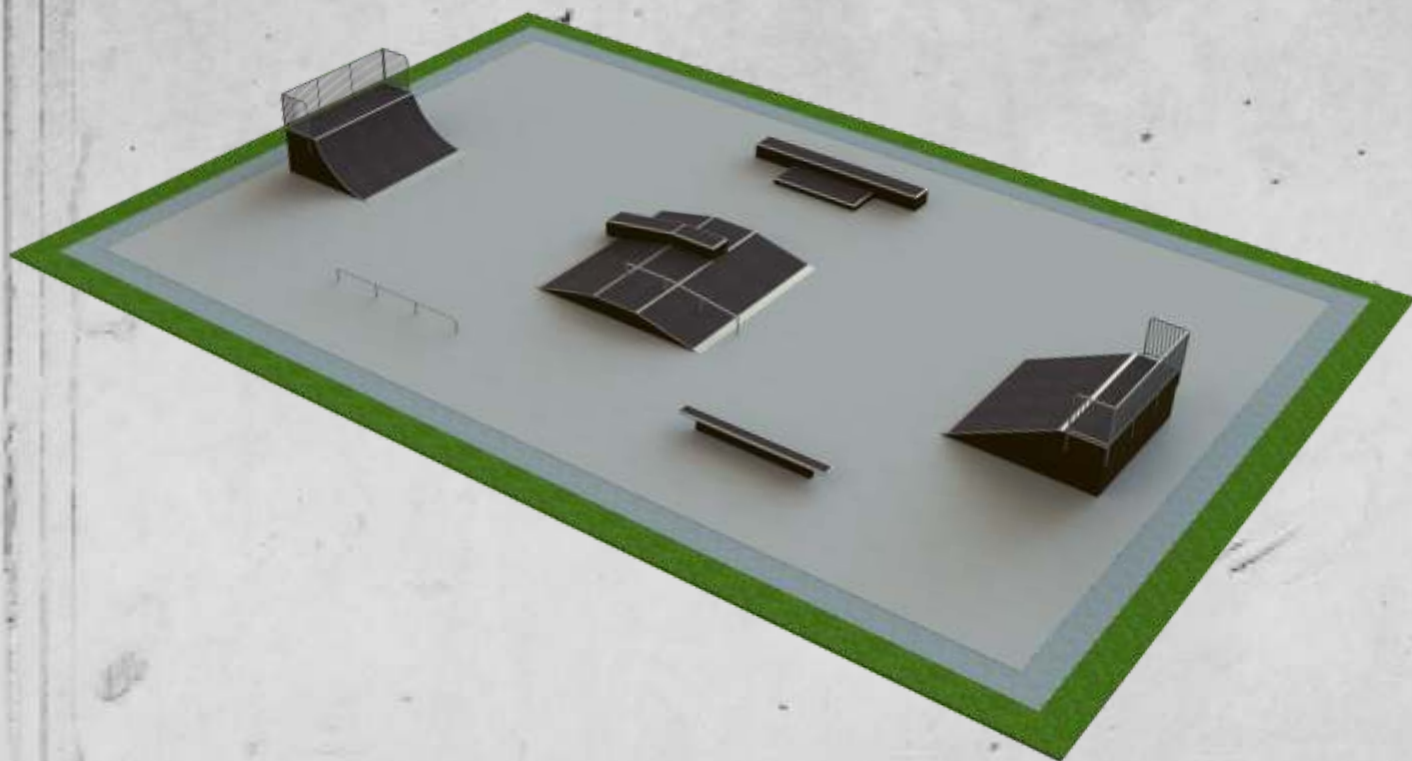



B 113

Park area: 1000m²
Riding surface: 100m²
Dimensions: 40x25x1.5m

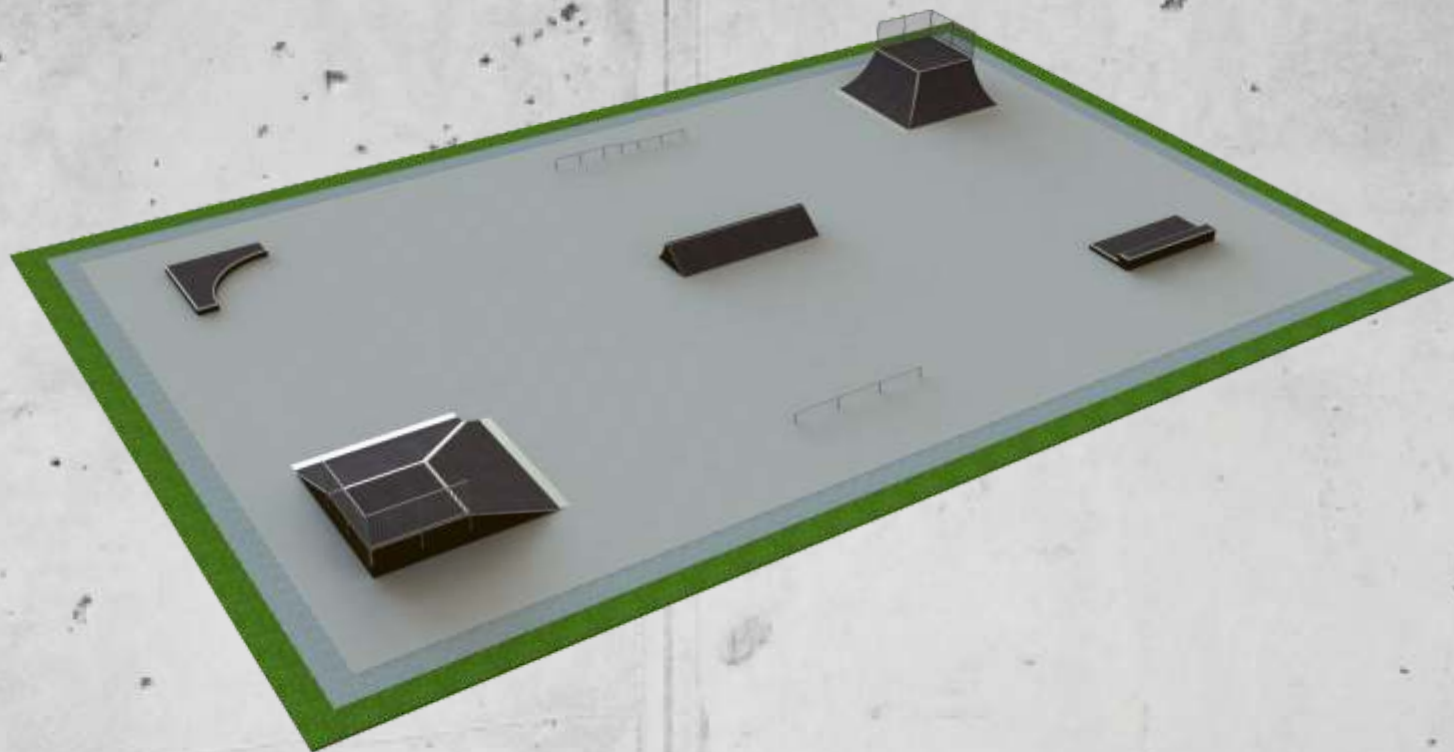

SKATEPARK



ooo



oo



oo



ooo

B 115

Park area: 450m²

Riding surface: 106m²

Dimensions: 30x15x1.5m

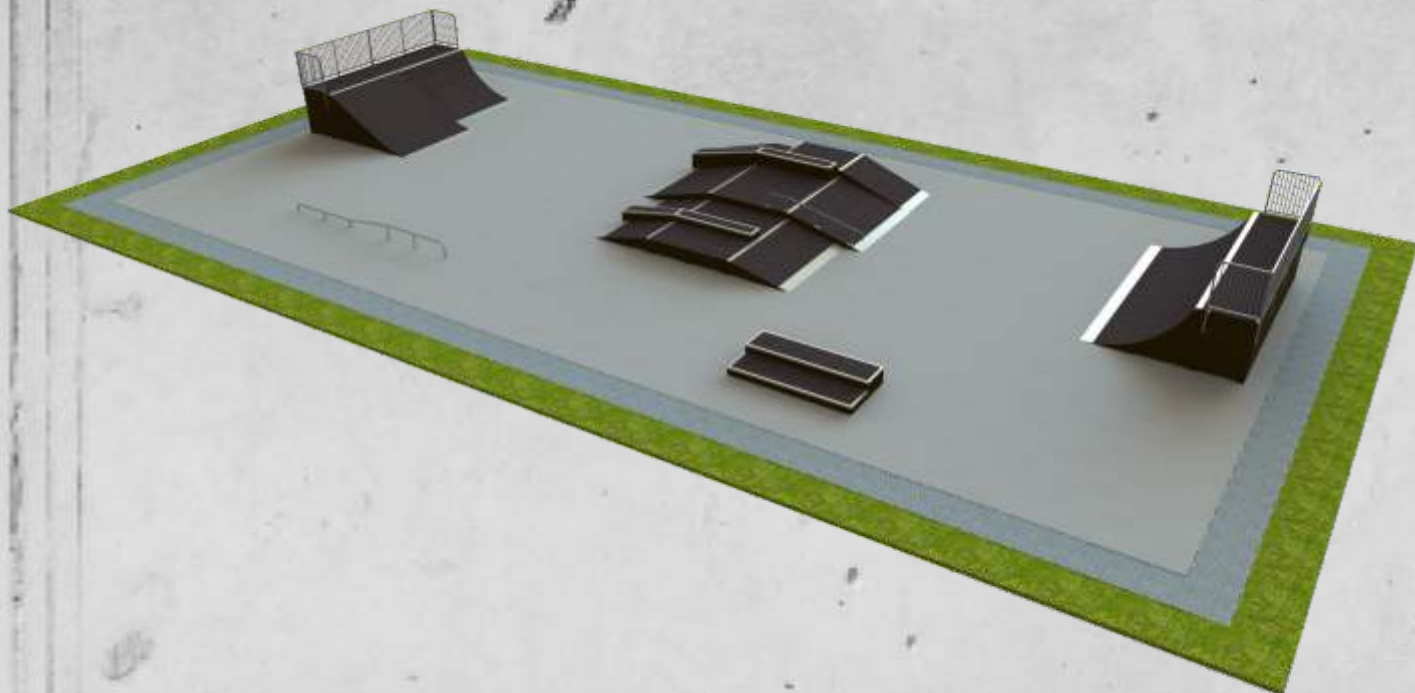



ooo



oo



o



ooo

B 120

Park area: 375m²

Riding surface: 121m²

Dimensions: 25x15x1.5m

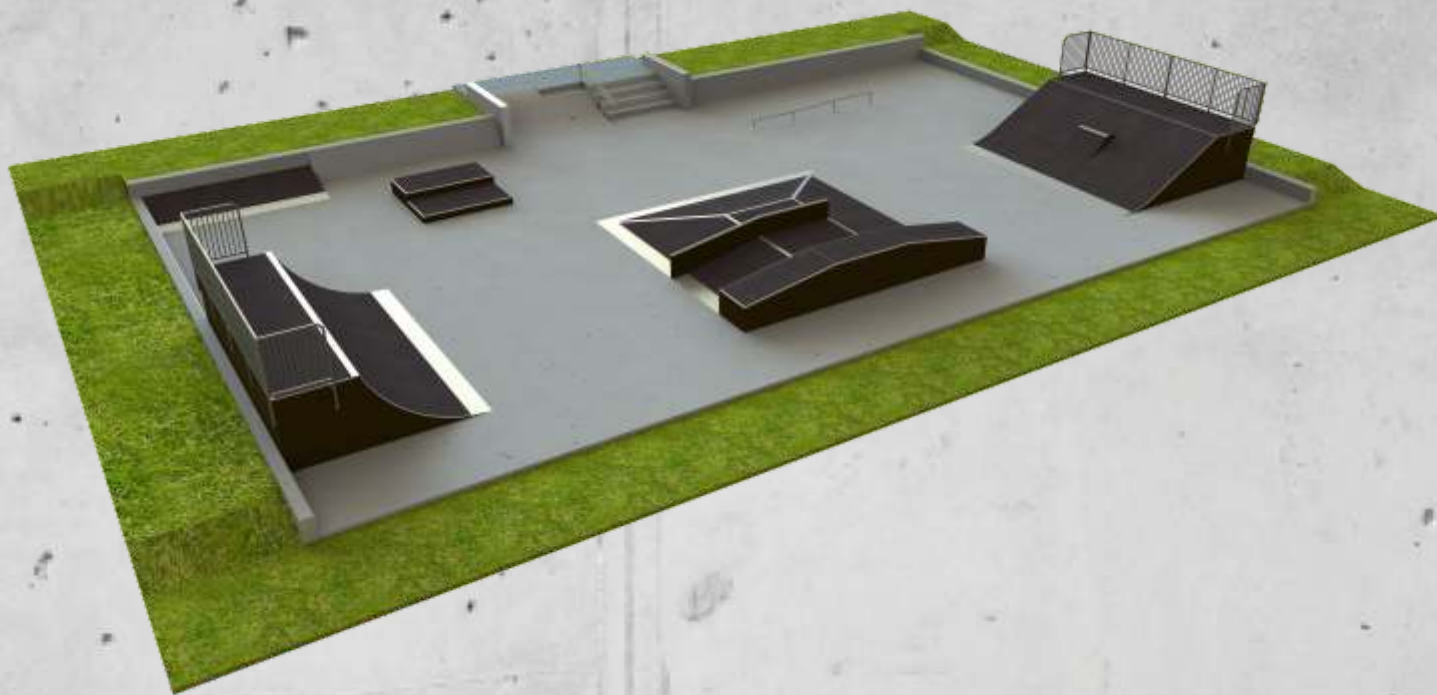

SKATEPARK



oo



oo



ooo



ooo

B 125

Park area: 336m²

Riding surface: 125m²

Dimensions: 28x12x2m

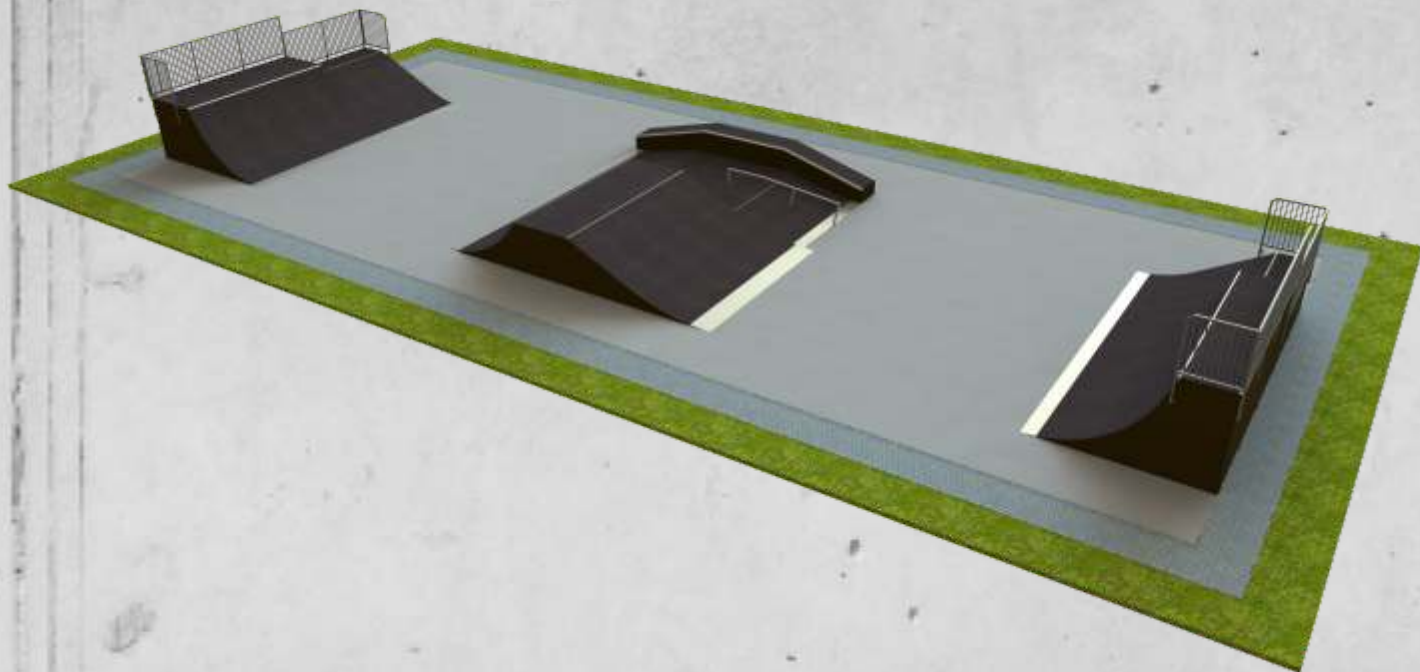



B 130

Park area: 338m²
Riding surface: 145m²
Dimensions: 26x13x2m

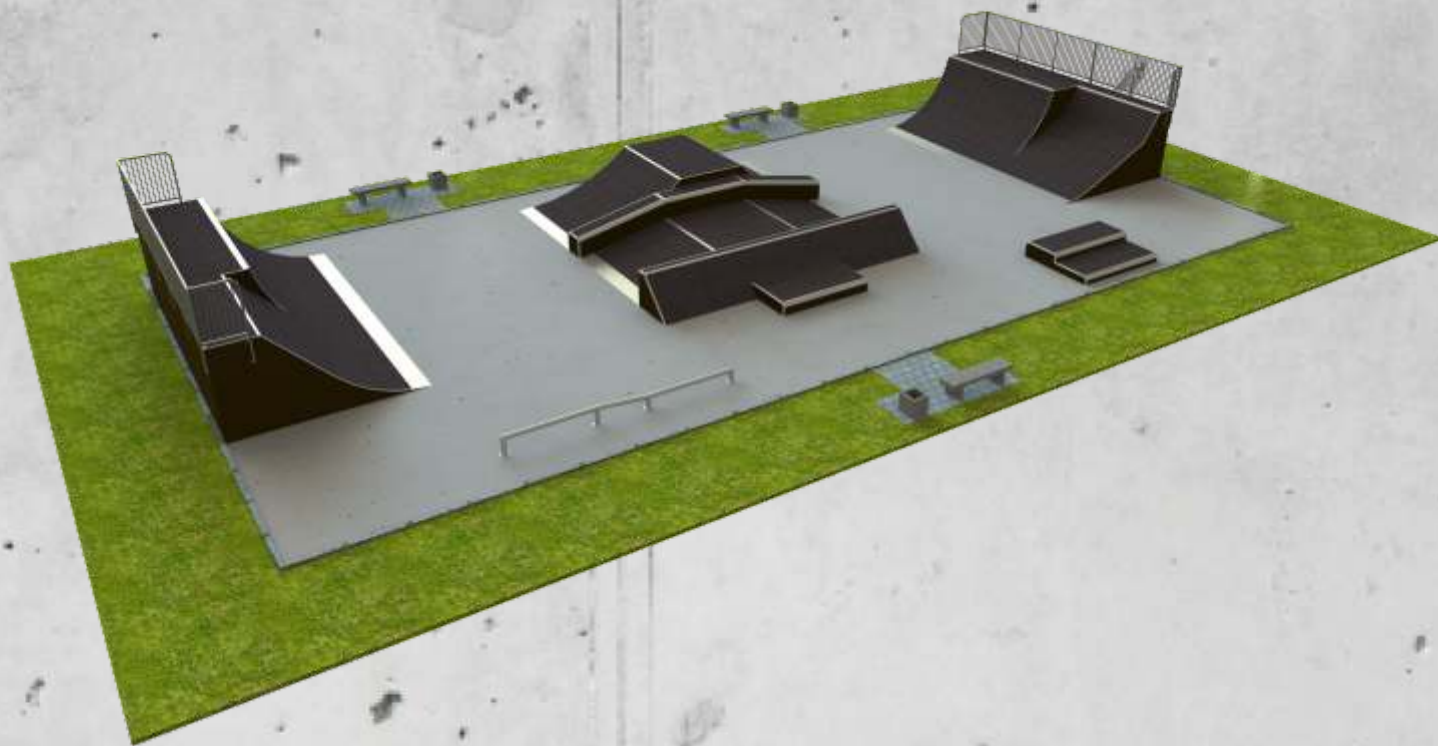

SKATEPARK



ooo



o



oo



ooo

B 132

Park area: 280m²

Riding surface: 150m²

Dimensions: 20x14x1.5m

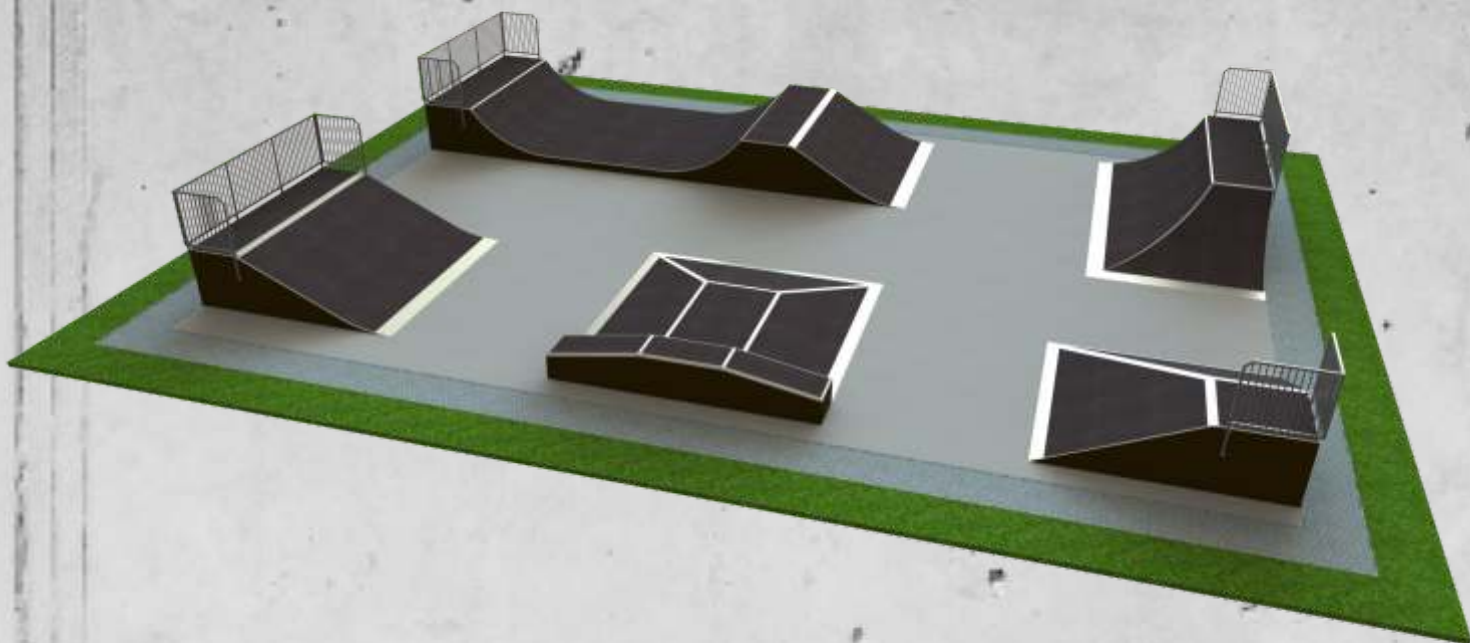



B 134

Park area: 875m²
Riding surface: 154m²
Dimensions: 35x25x3.5m

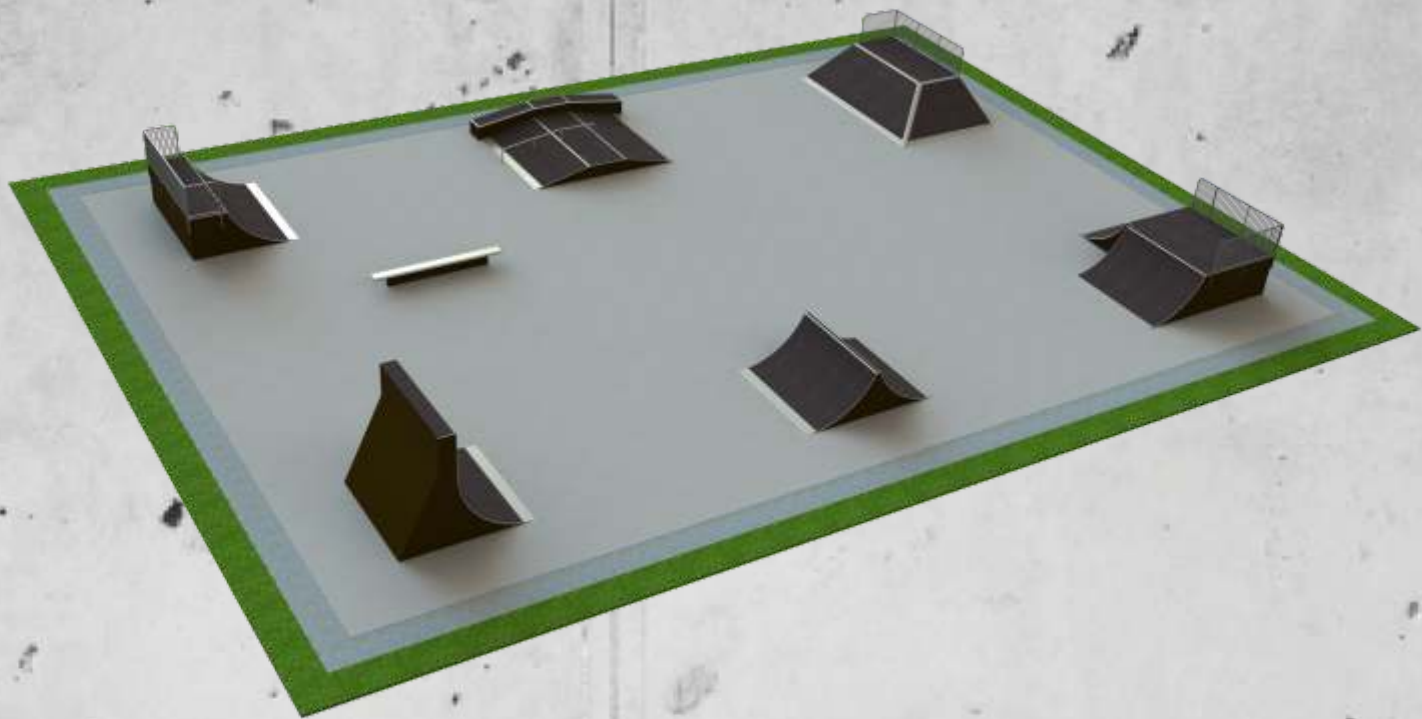

SKATEPARK



ooo



oo



oo



ooo

B 135

Park area: 440m²

Riding surface: 153m²

Dimensions: 29x29x9x1.5m

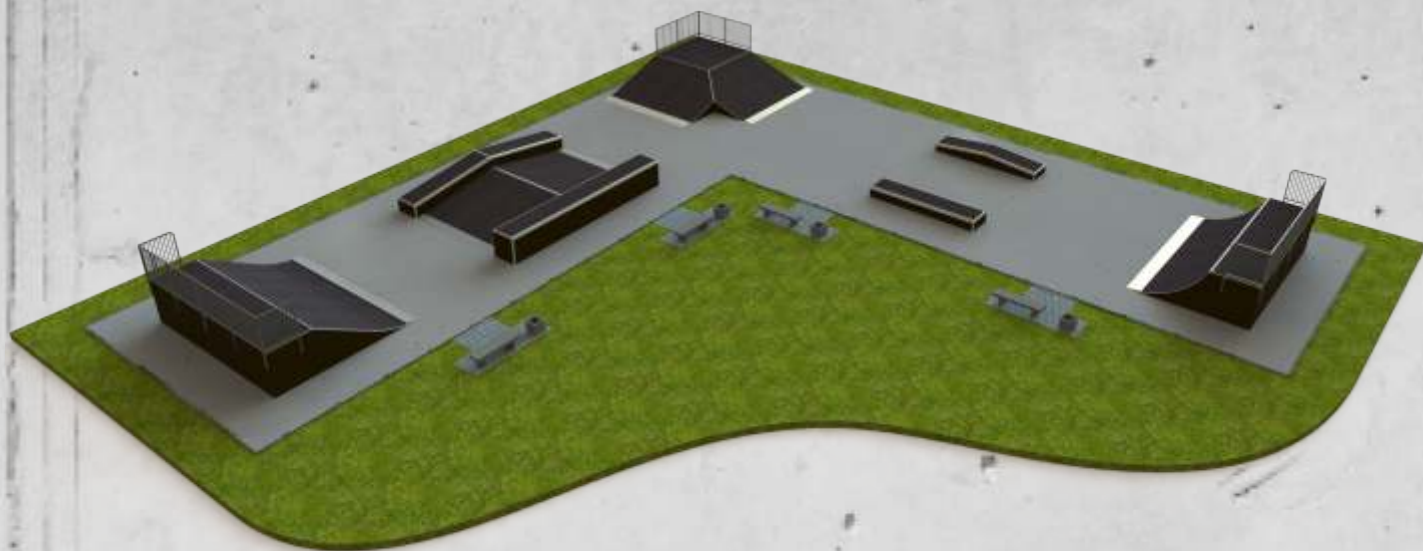



ooo



oo



o



ooo

B 140

Park area: 260m²

Riding surface: 150m²

Dimensions: 20x13x1.2m

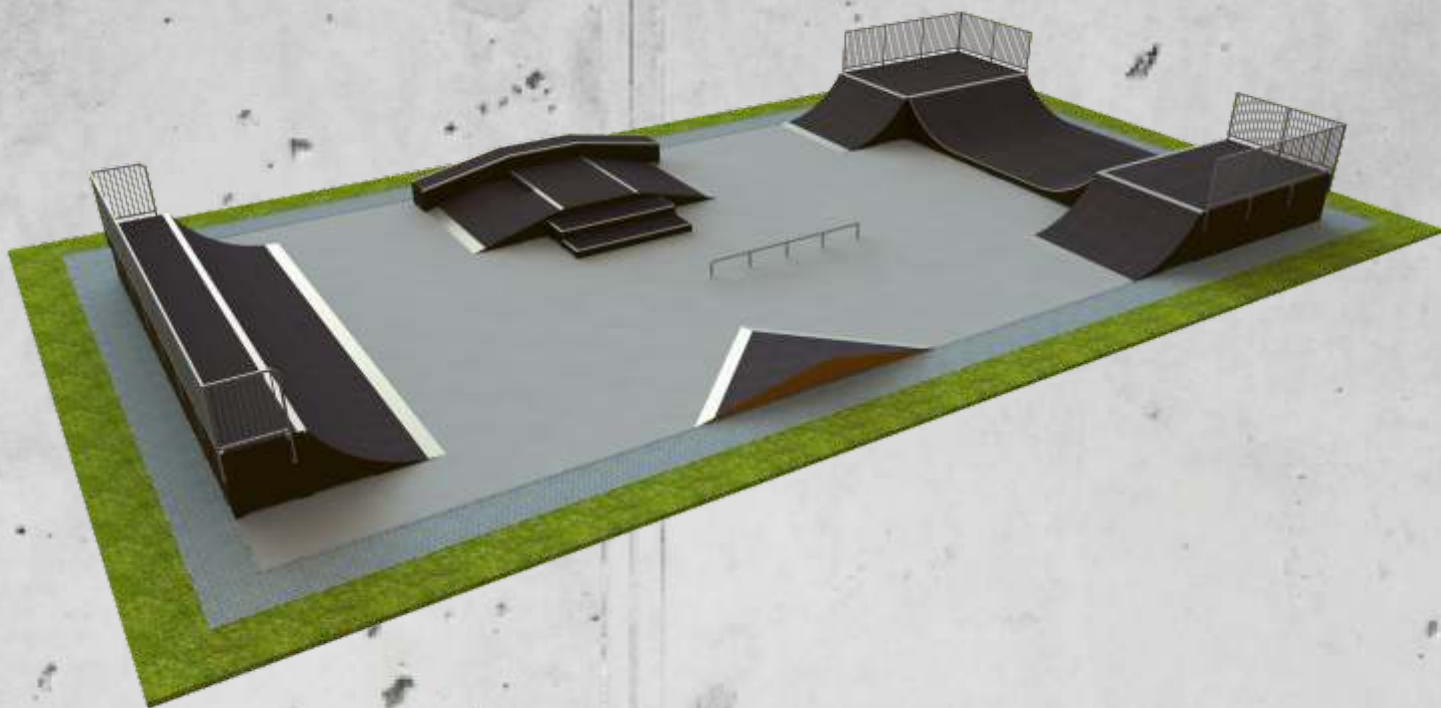

SKATEPARK



oo



oo



o



ooo

B 141

Park area: 1000m²

Riding surface: 154m²

Dimensions: 40x25x1.5m

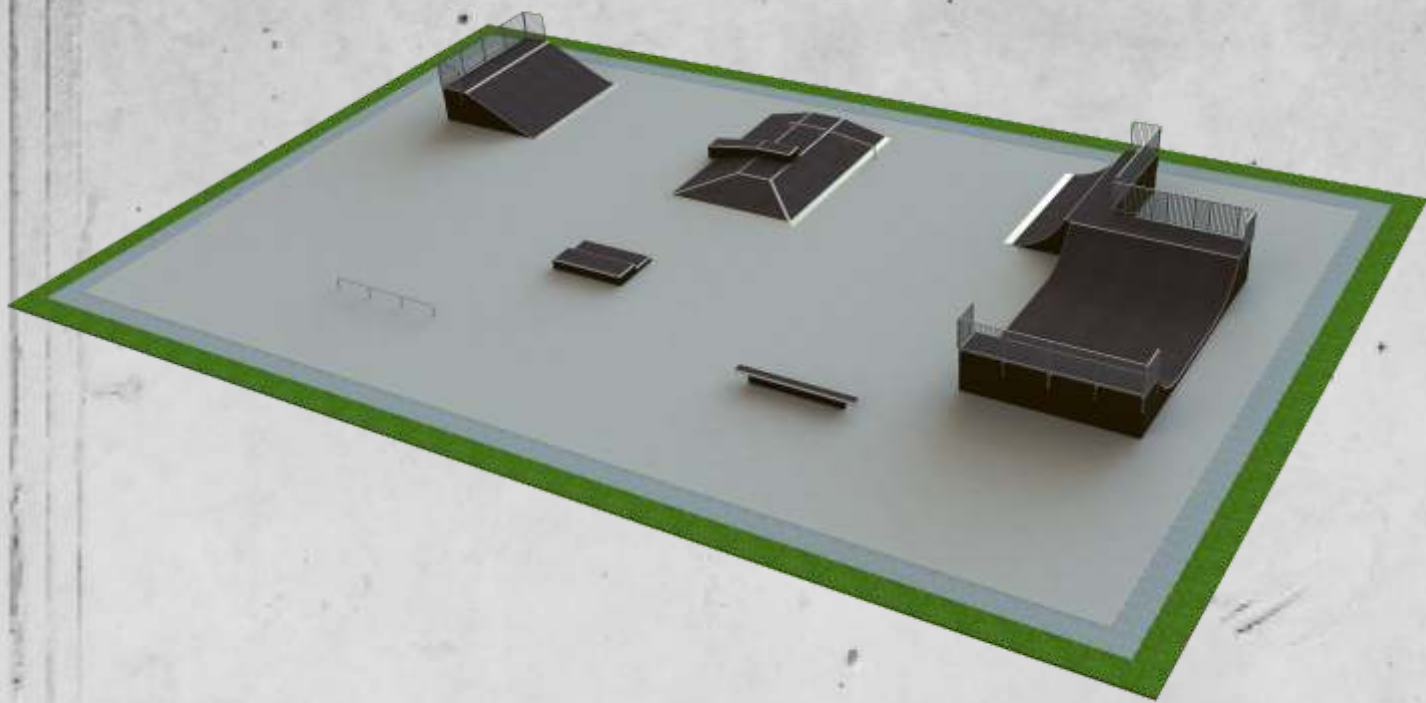



B 143

Park area: 1200m²
Riding surface: 170m²
Dimensions: 40x30x1.5m

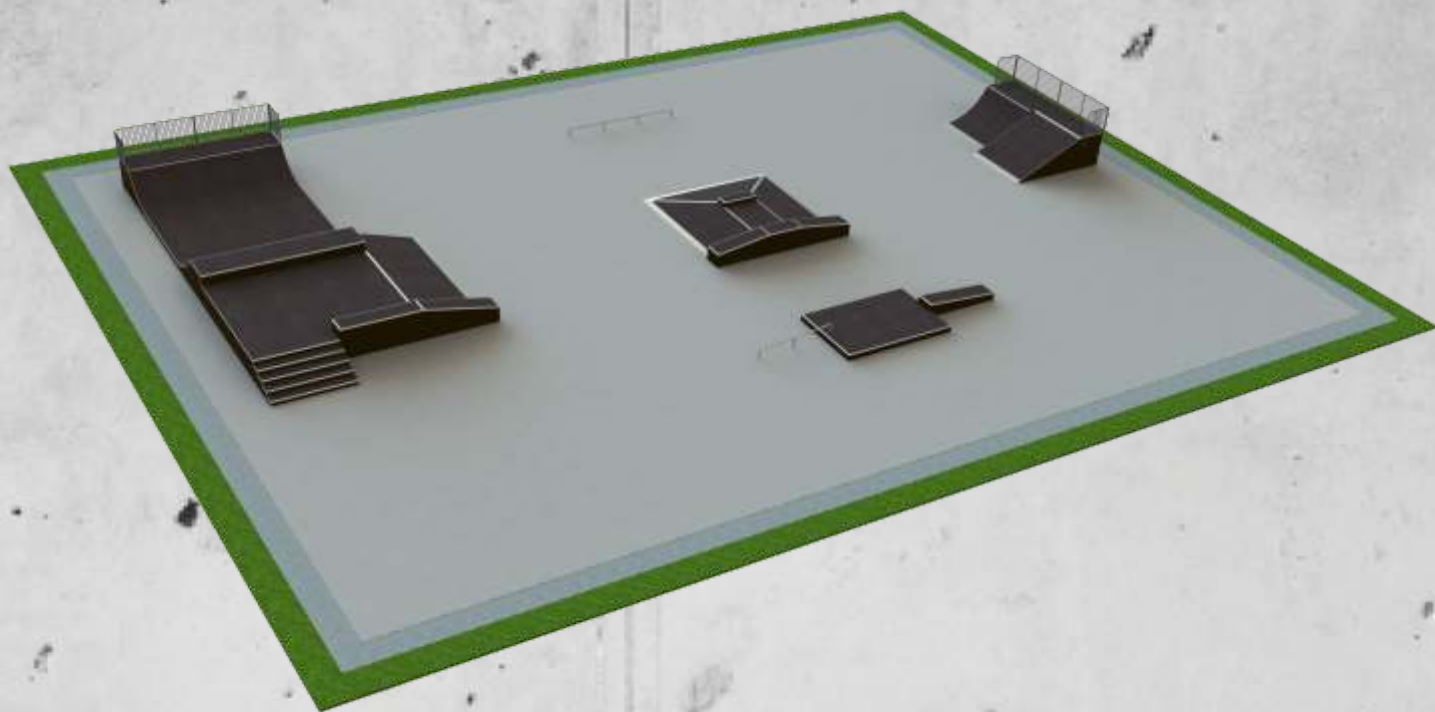

SKATEPARK



oo



oo



oo



ooo

B 144

Park area: 750m²

Riding surface: 155m²

Dimensions: 30x25x1.5m

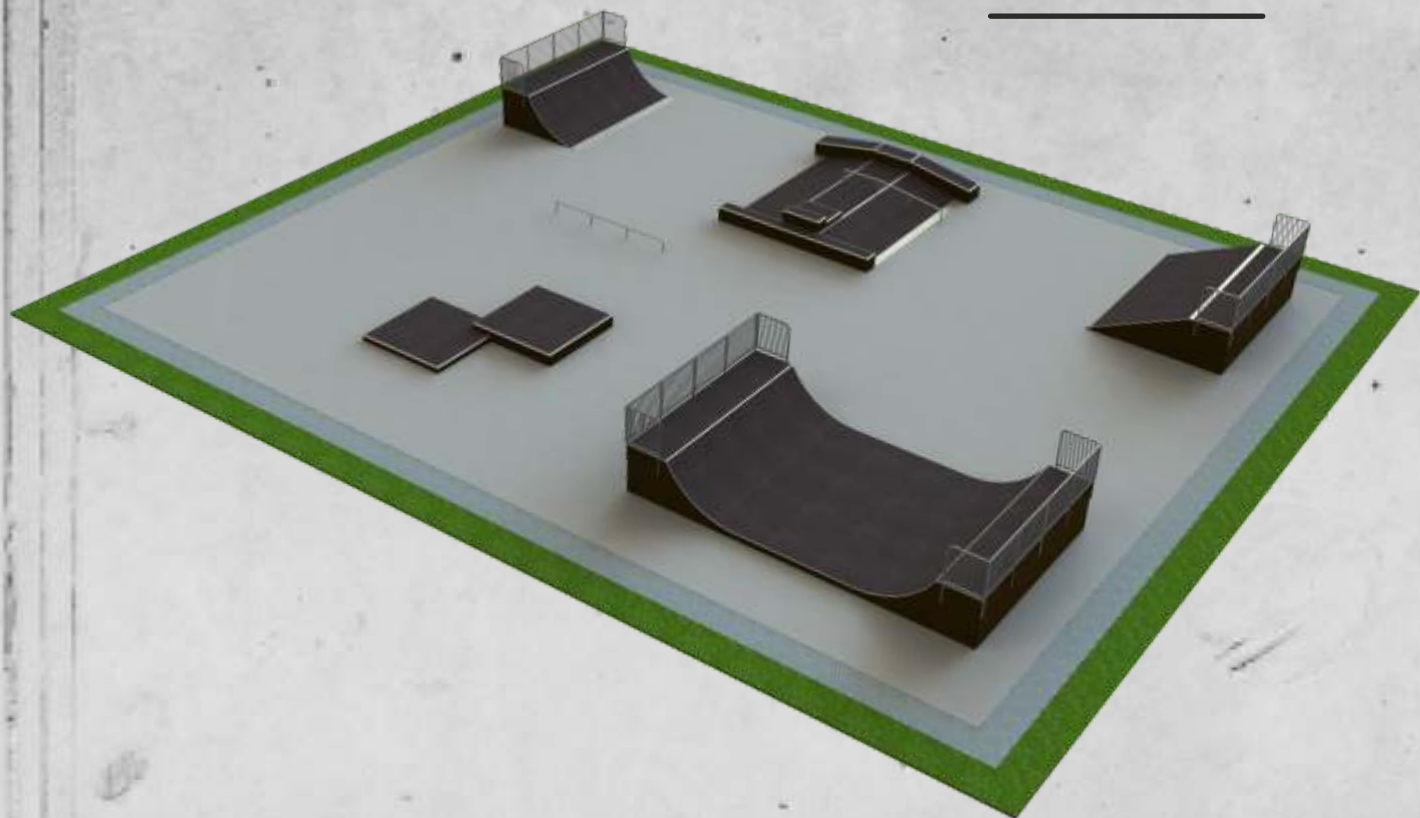



B 145

Park area: 700m²
Riding surface: 160m²
Dimensions: 35x20x1.5m

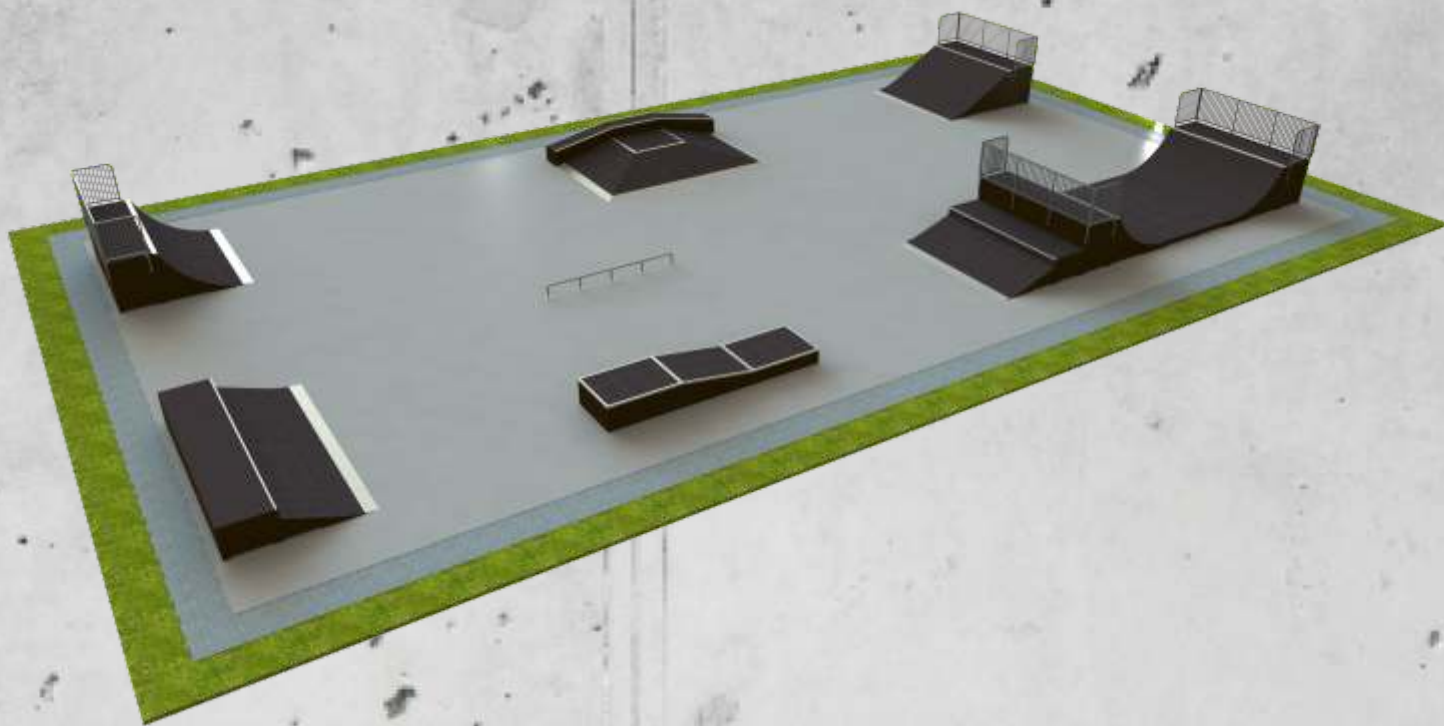

SKATEPARK



ooo



ooo



oo



ooo

B 150

Park area: 400m²

Riding surface: 183m²

Dimensions: 40x10x1.5m

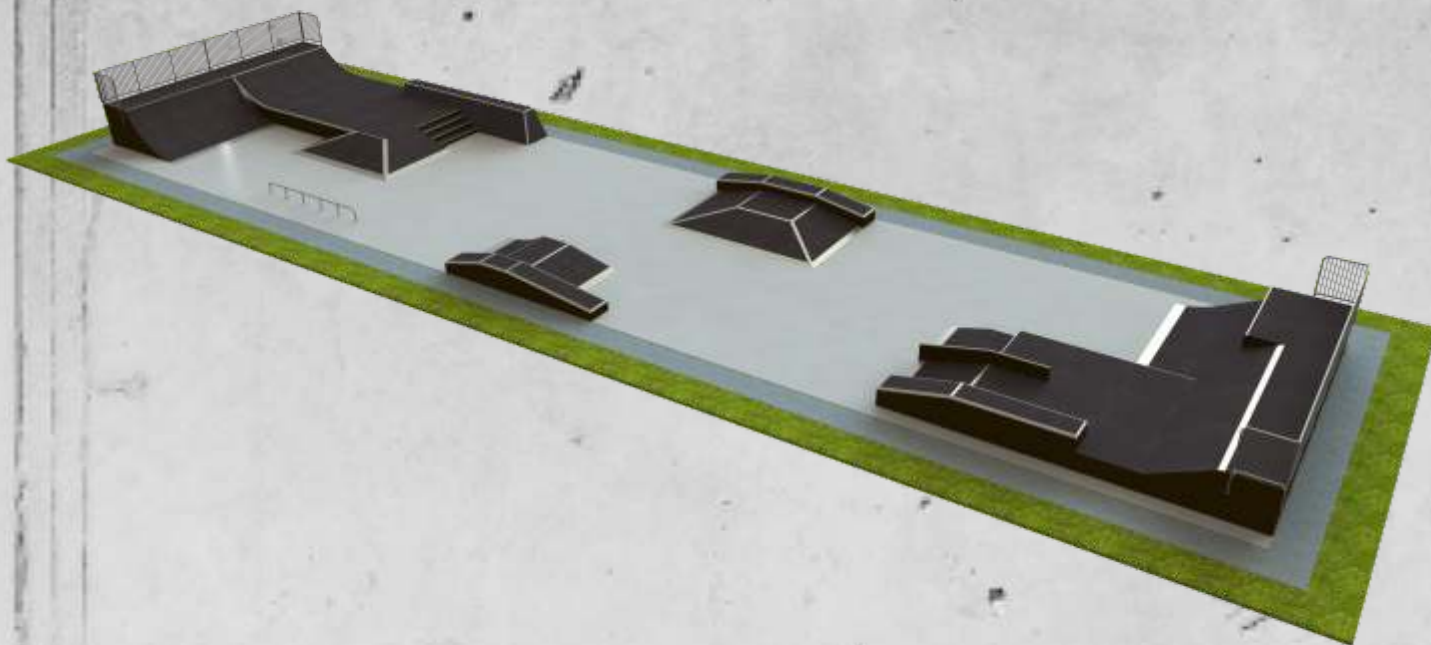



B 155

Park area: 700m²
Riding surface: 196m²
Dimensions: 35x20x3m

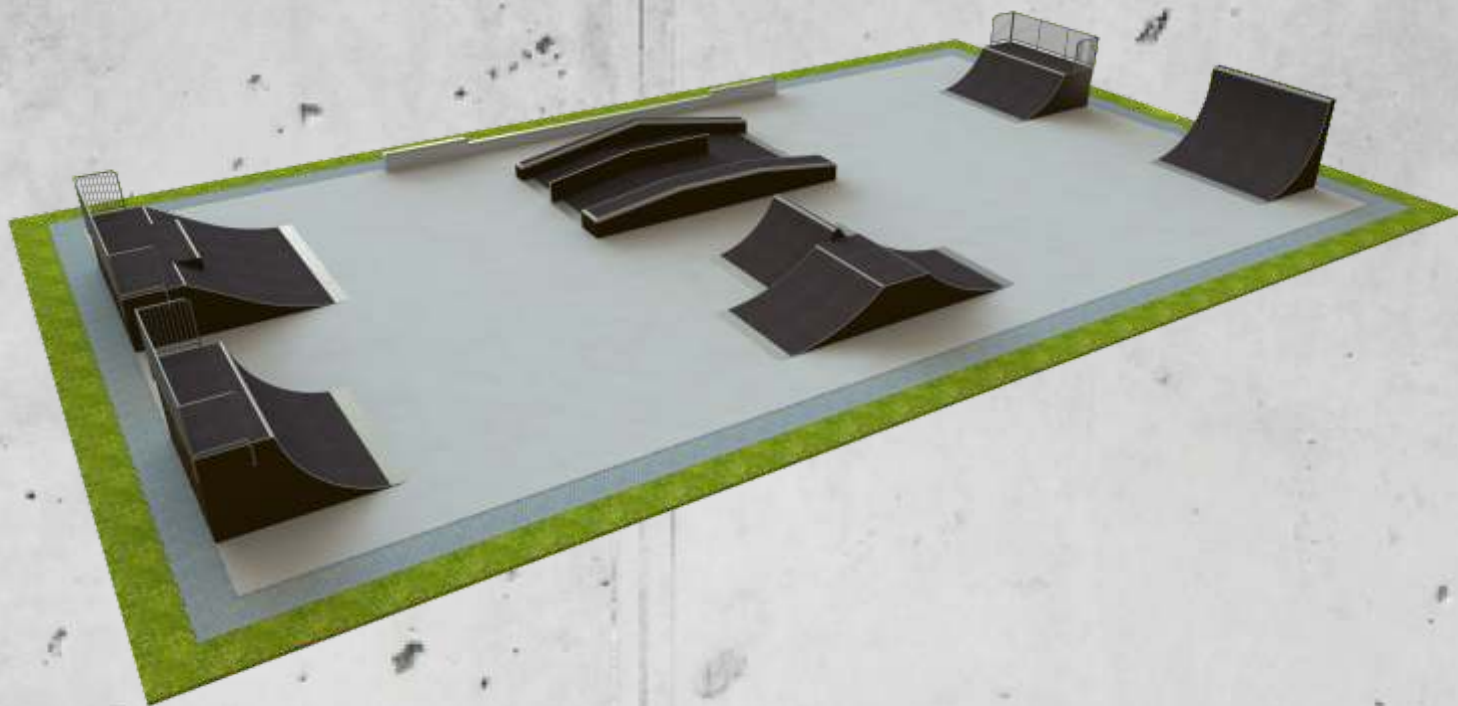

SKATEPARK



oo



oo



oo



oo

B 156

Park area: 295m²

Riding surface: 145m²

Dimensions: 45x12x4m

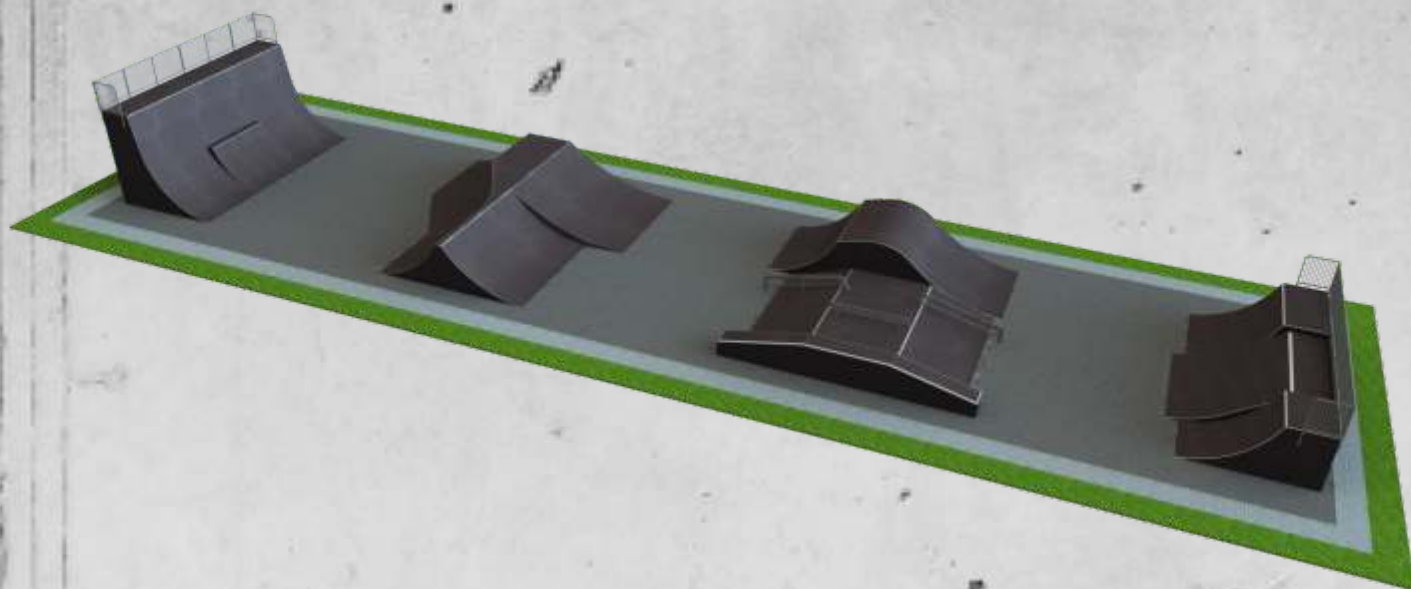



ooo



oo



ooo



ooo

B 157

Park area: 450m²
Riding surface: 243m²
Dimensions: 30x15x1.8m

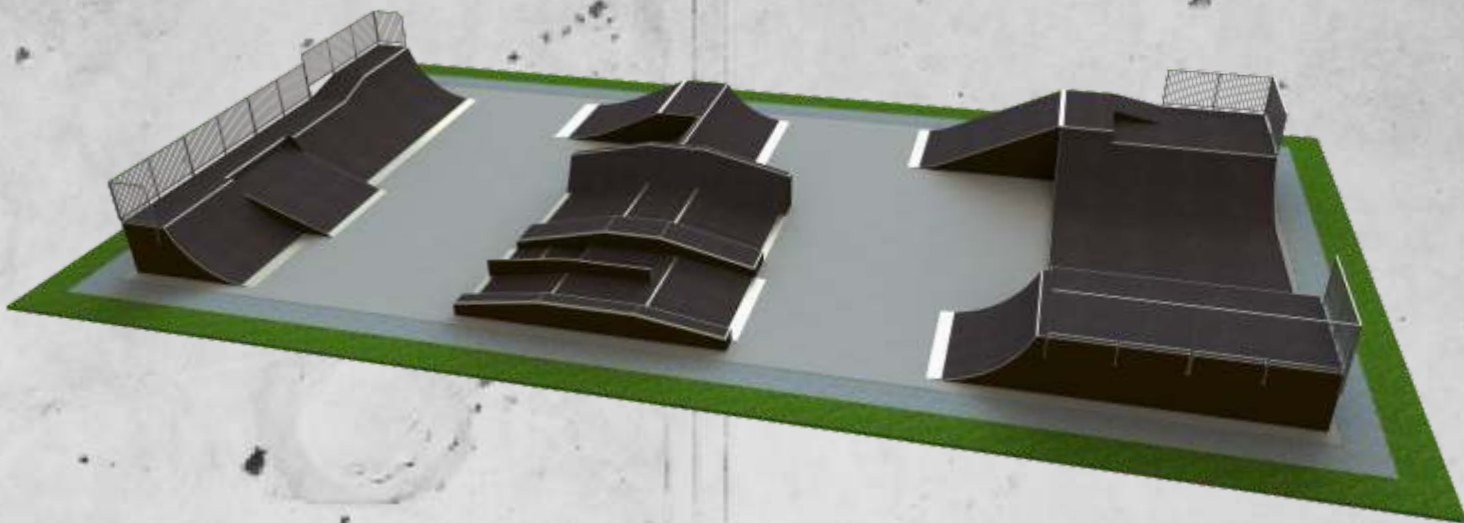

SKATEPARK



ooo



oo



oo

B 160

Park area: 700m²

Riding surface: 209m²

Dimensions: 35x20x1.7m

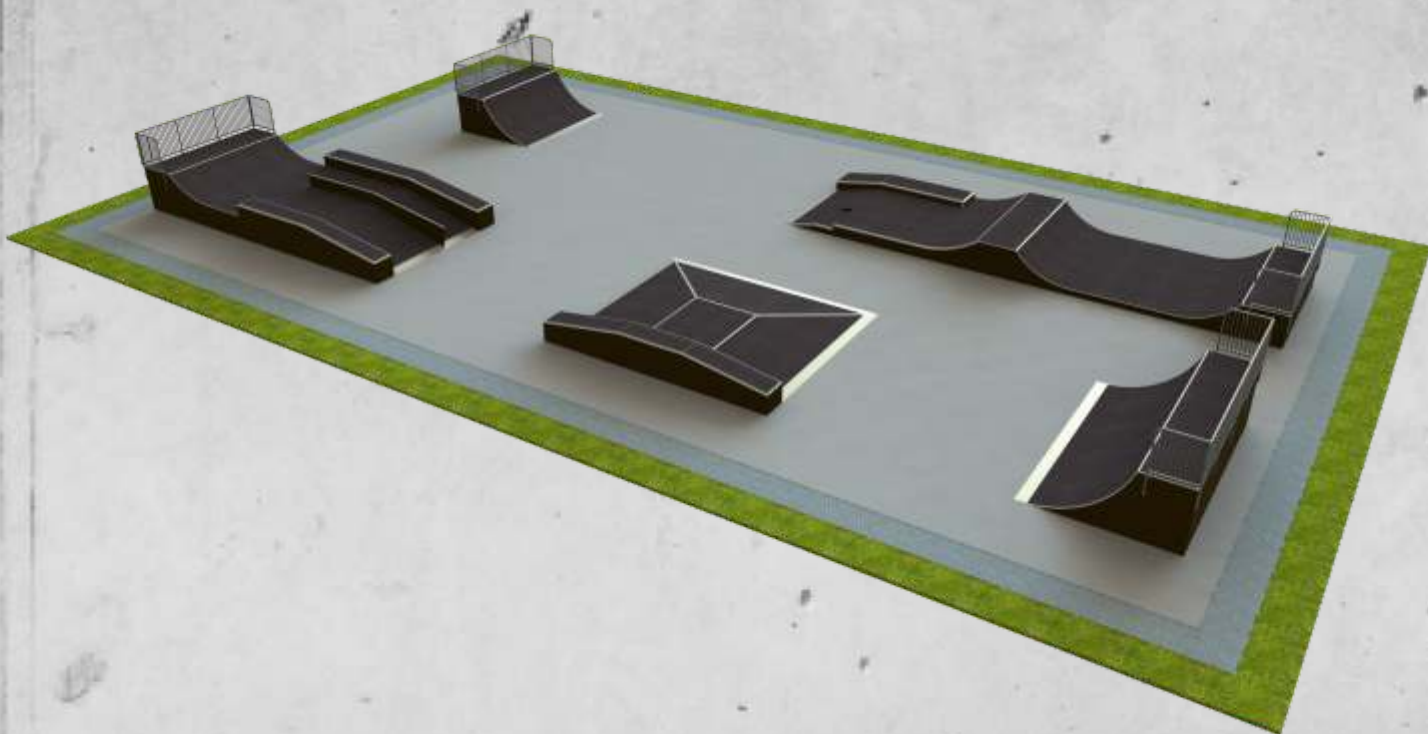



ooo



ooo



oo



ooo

B 165

Park area: 700m²
Riding surface: 236m²
Dimensions: 35x20x3m

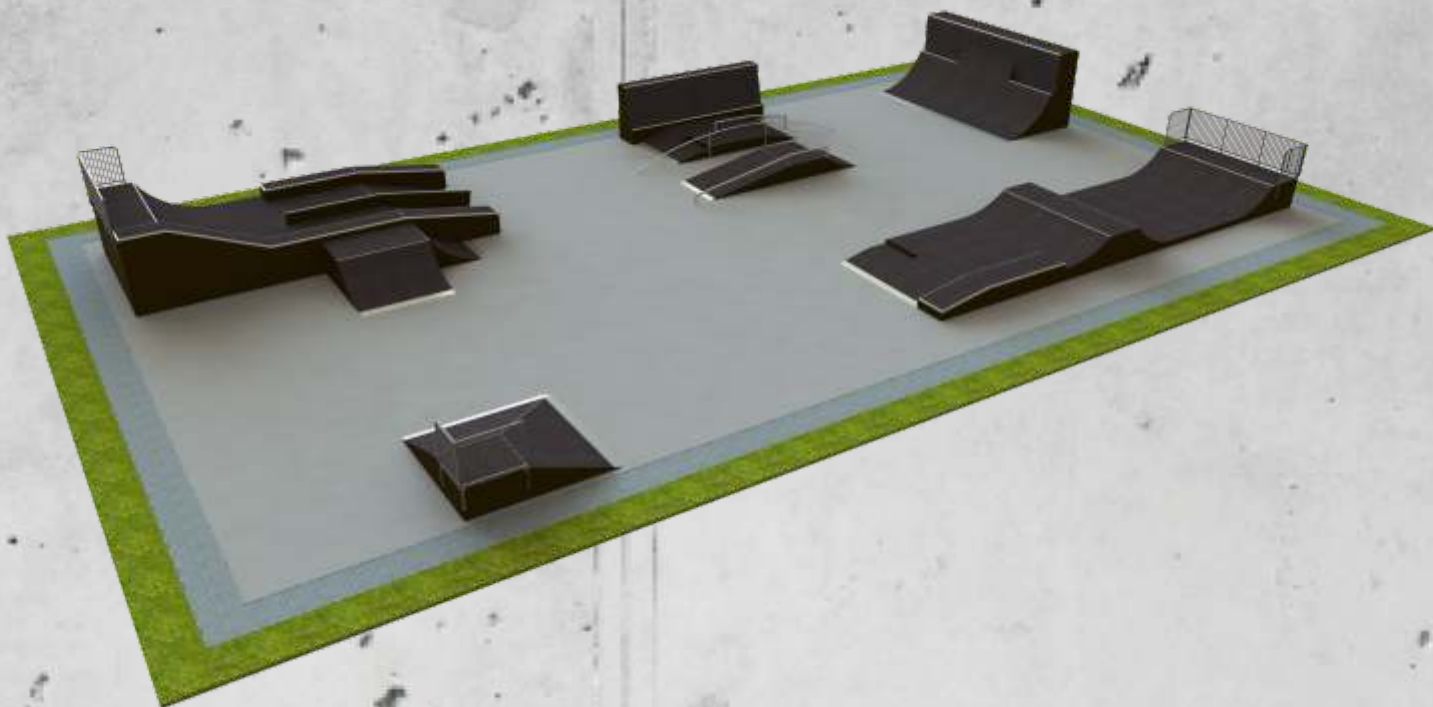

SKATEPARK



o



oo



ooo



ooo

B 170

Park area: 600m²

Riding surface: 215m²

Dimensions: 30x20x3m





O



OO



OOO



OOO

B 175

Park area: 900m²

Riding surface: 236m²

Dimensions: 60x15x3m

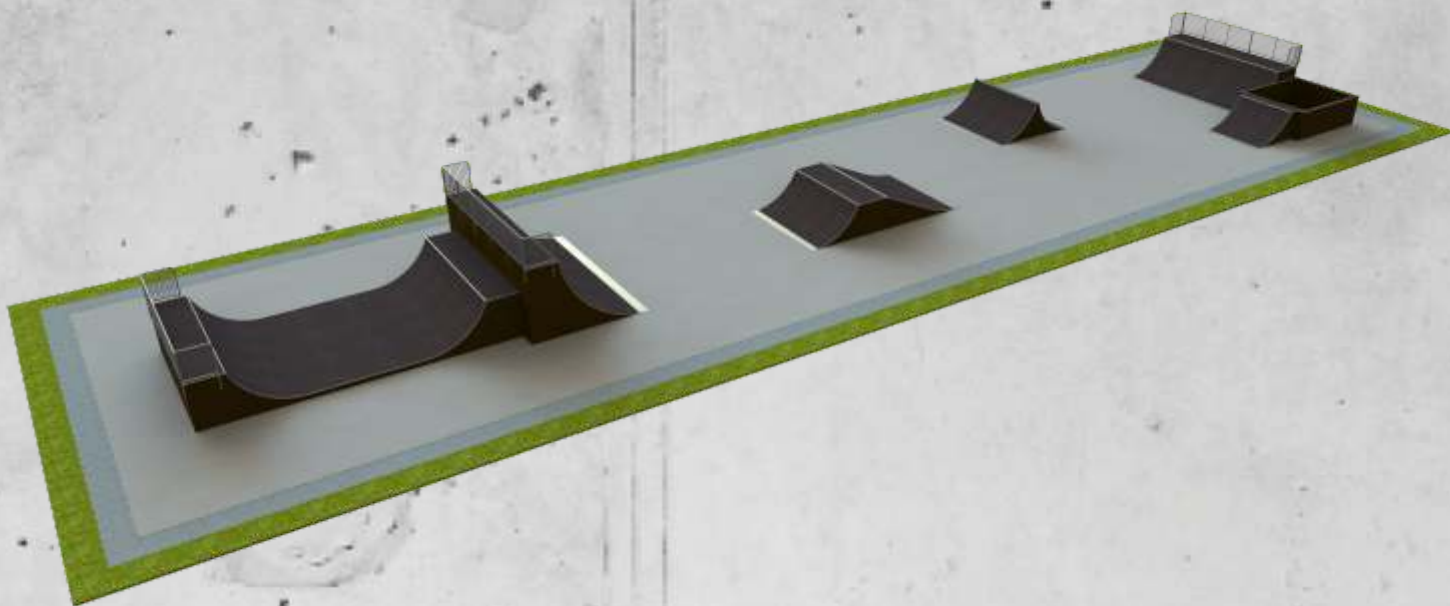

SKATEPARK



ooo



ooo



ooo



ooo

B 178

Park area: 552m²

Riding surface: 251m²

Dimensions: 46x12x2m

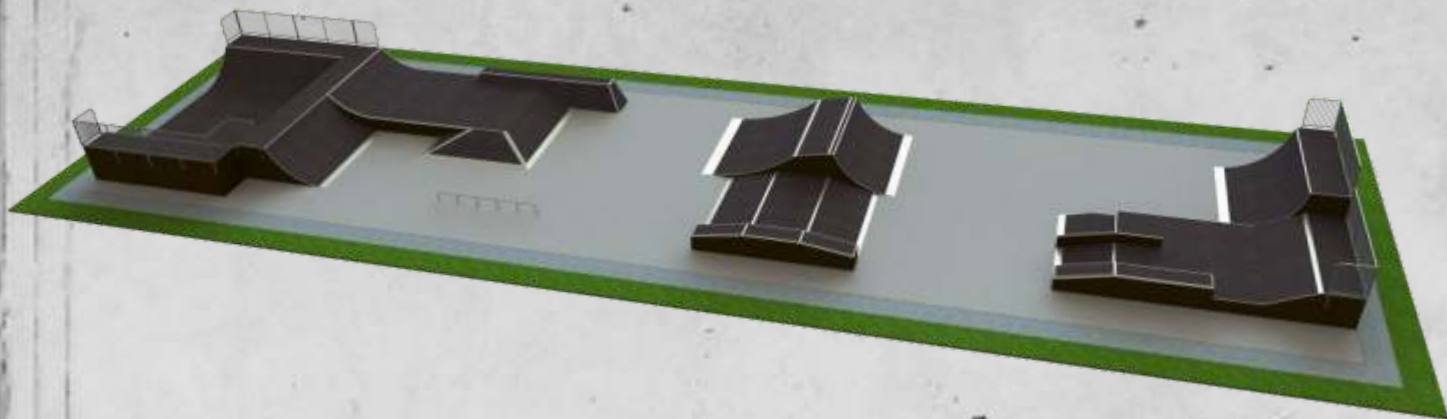



B 180

Park area: 630m²
Riding surface: 267m²
Dimensions: 35x18x2m

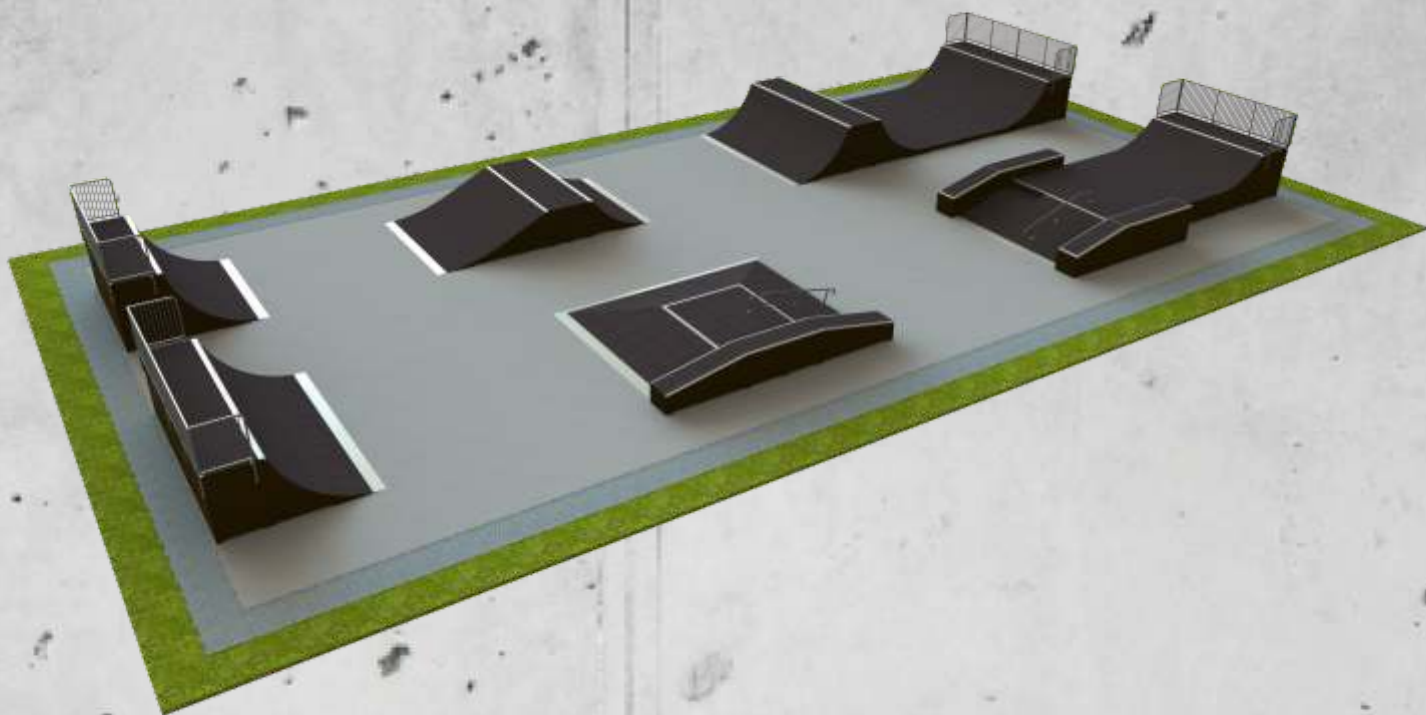

SKATEPARK



ooo



oo



ooo



ooo

B 181

Park area: 630m²

Riding surface: 286m²

Dimensions: 35x18x3.5m

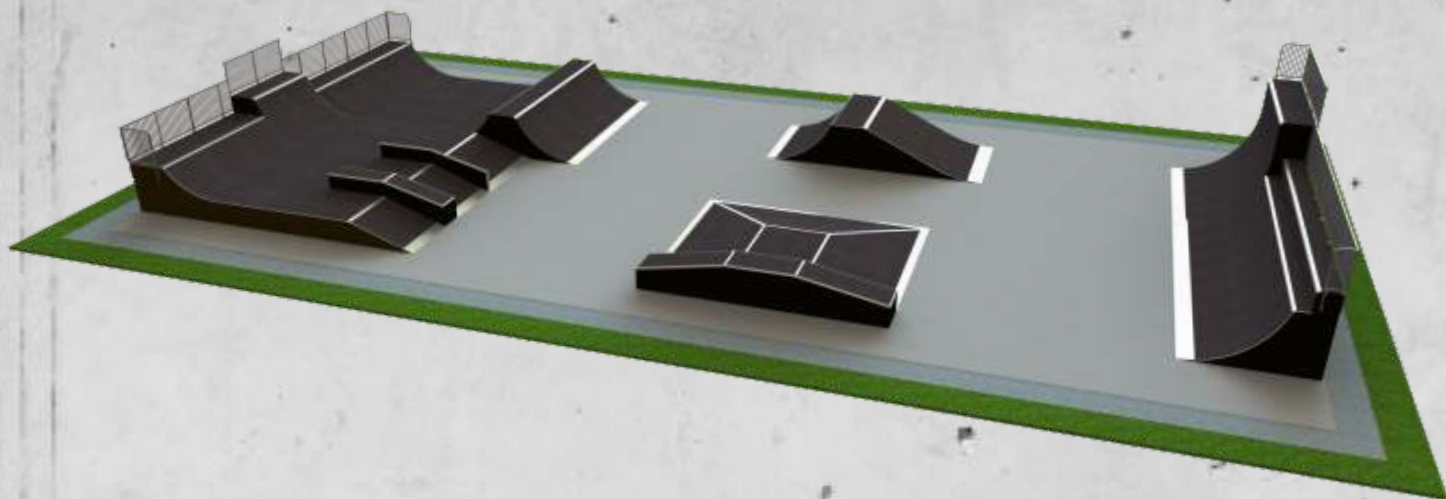



ooo



ooo



ooo



ooo

B 184

Park area: 760m²
Riding surface: 360m²
Dimensions: 38x20x4m

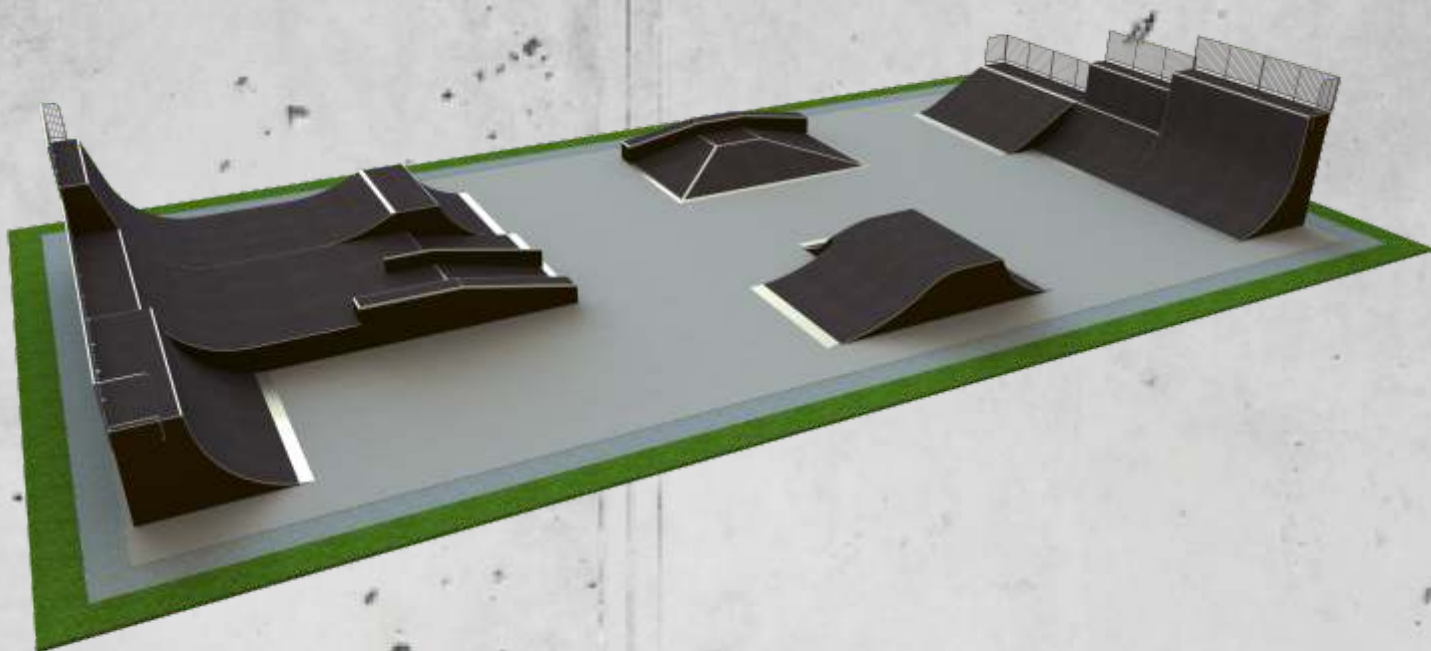

SKATEPARK



oo



oo



oo



ooo

B 185

Park area: 990m²

Riding surface: 360m²

Dimensions: 33x30xm





ooo



ooo



ooo



ooo

B 186

Park area: 700m²

Riding surface: 375m²

Dimensions: 35x20x3m

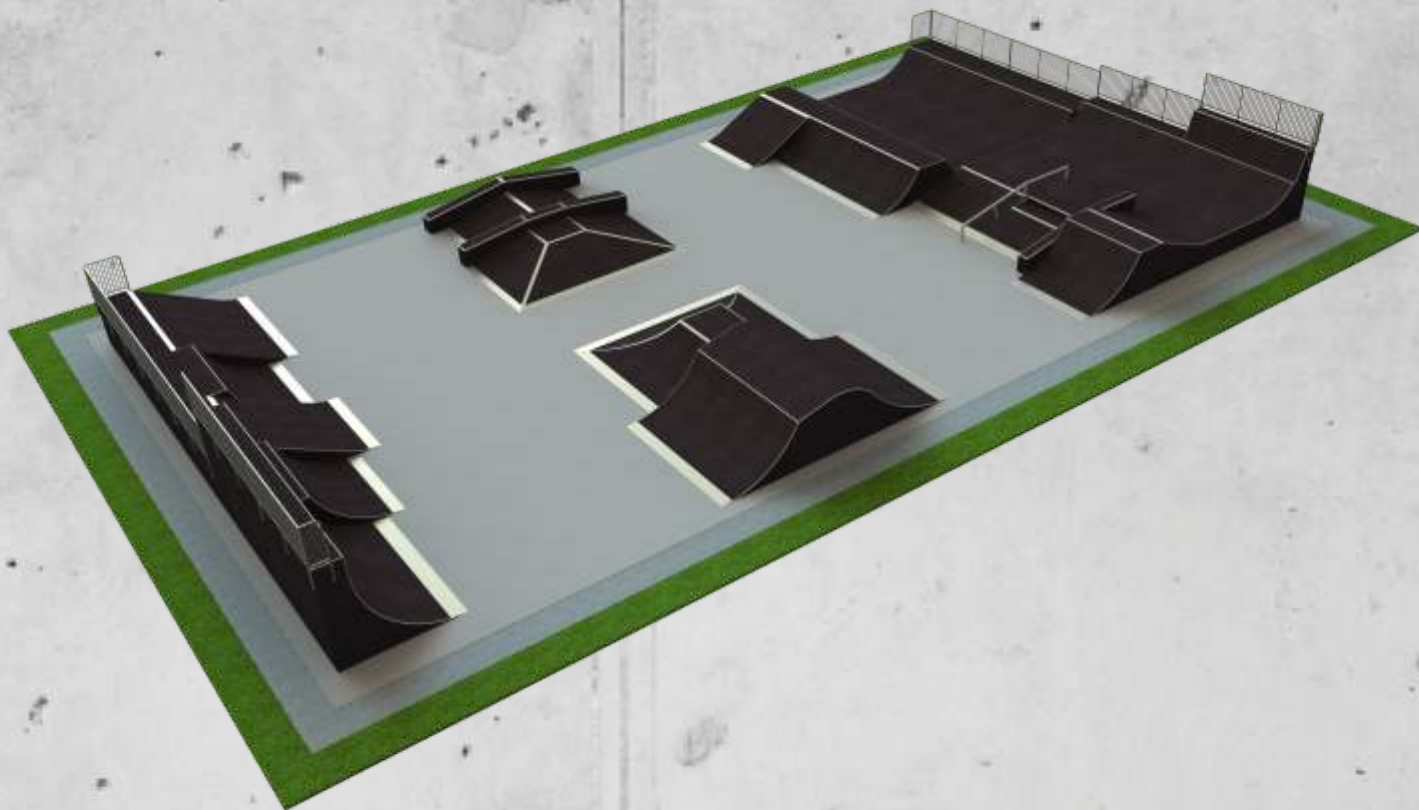

SKATEPARK



ooo



oo



oo



ooo

B 190

Park area: 930m²

Riding surface: 380m²

Dimensions: 50x37x12x2m

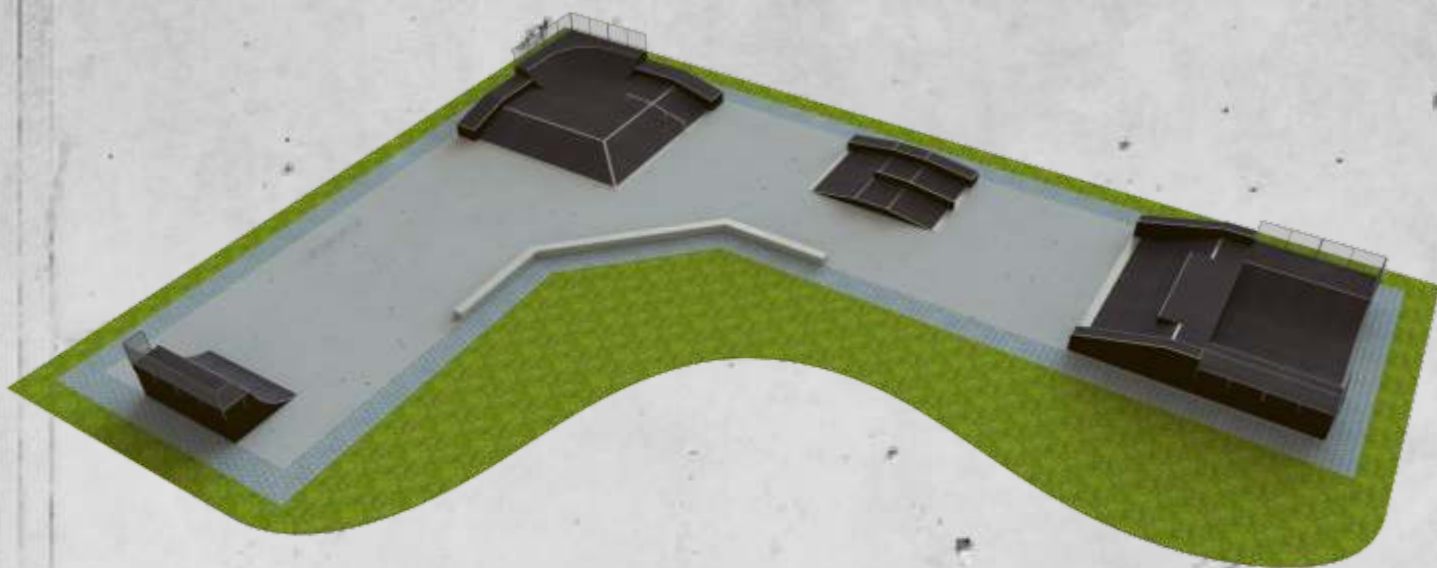

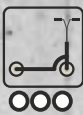

B 195

Park area: 750m²
Riding surface: 375m²
Dimensions: 30x25x4m

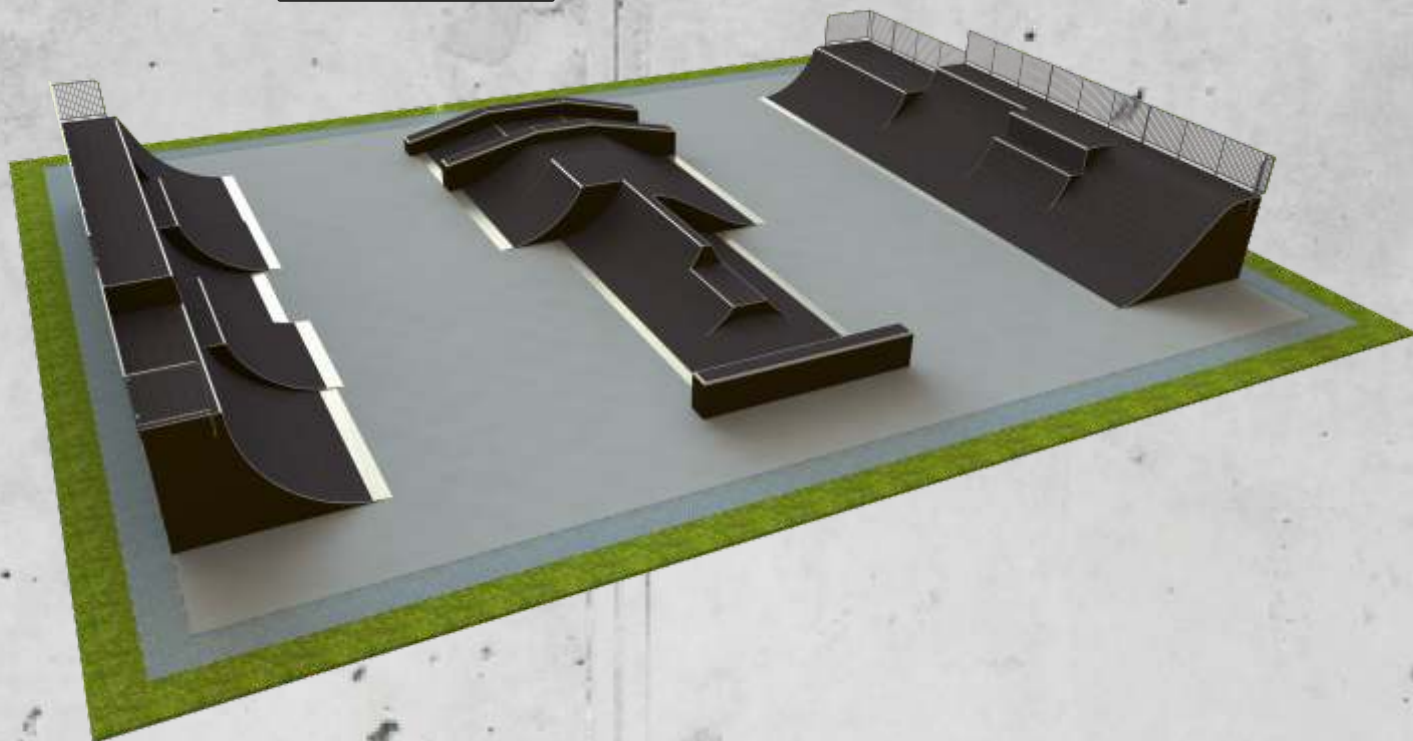

SKATEPARK



ooo



oo



oo



ooo

B 200

Park area: 2000m²

Riding surface: 468m²

Dimensions: 55x40x3.5m

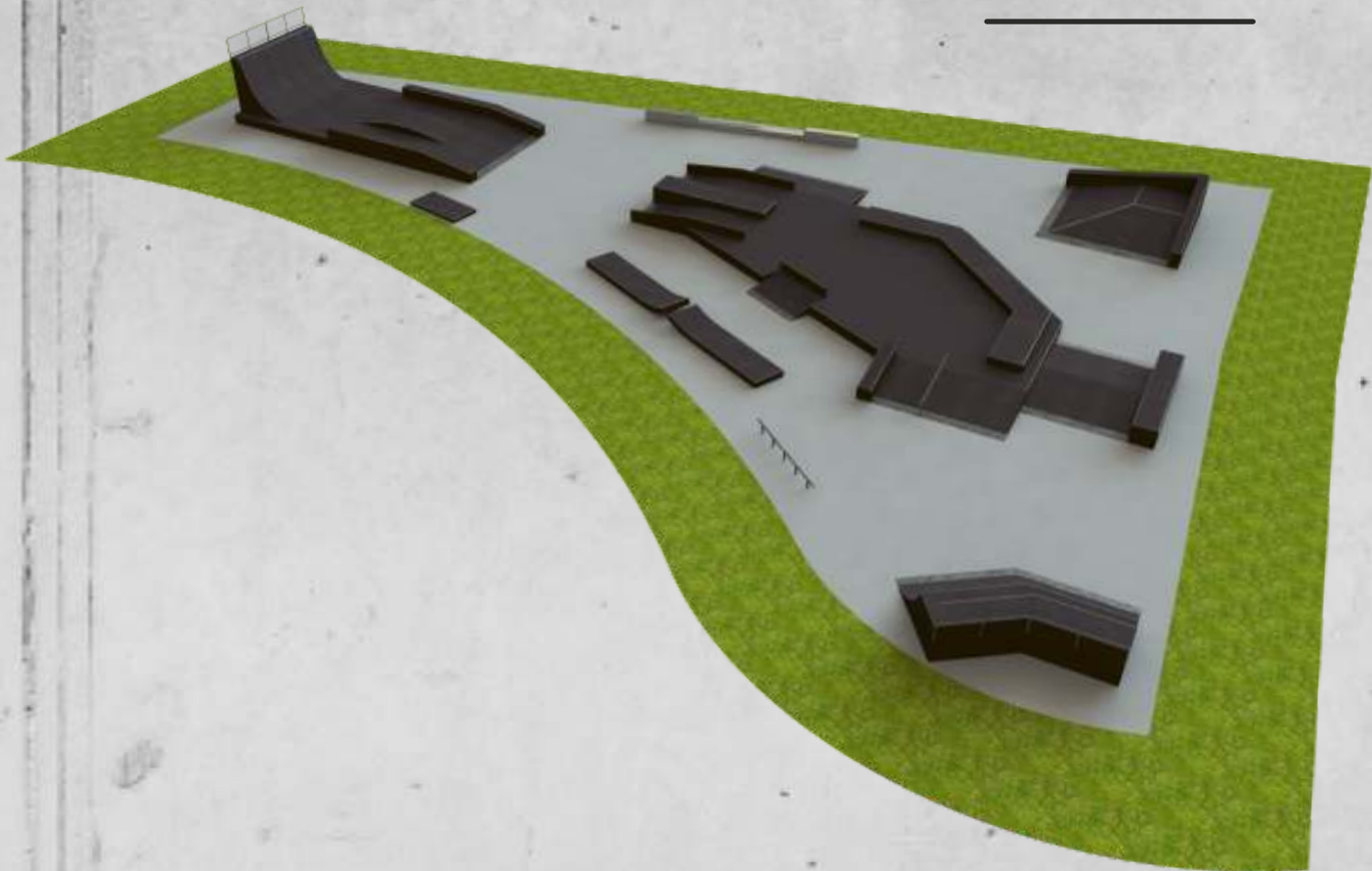



ooo



oo



ooo



ooo

B 205

Park area: 594m²

Riding surface: 295m²

Dimensions: 33x18x3m

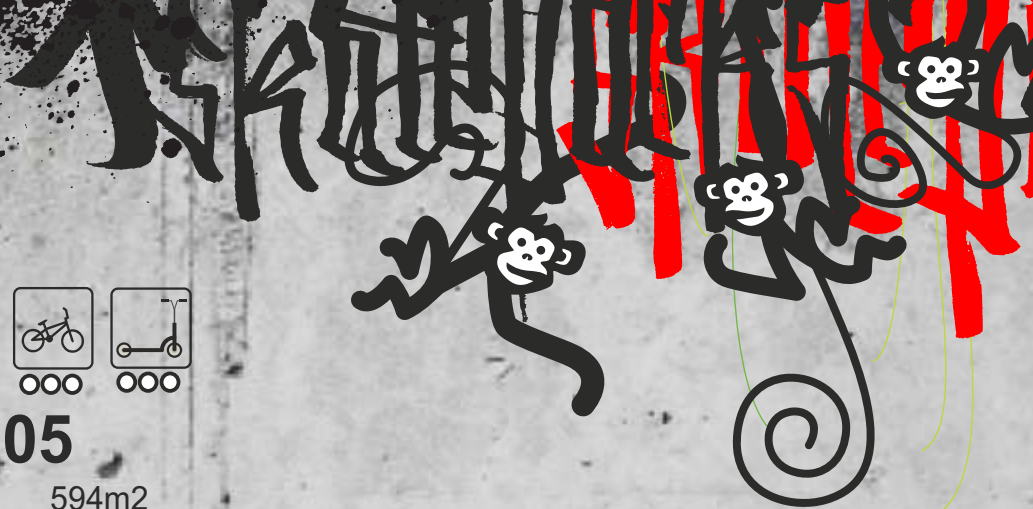

SKATEPARK



000



000



000



000

B 220

Park area: 2000m²

Riding surface: 512m²

Dimensions: 50x40x3m

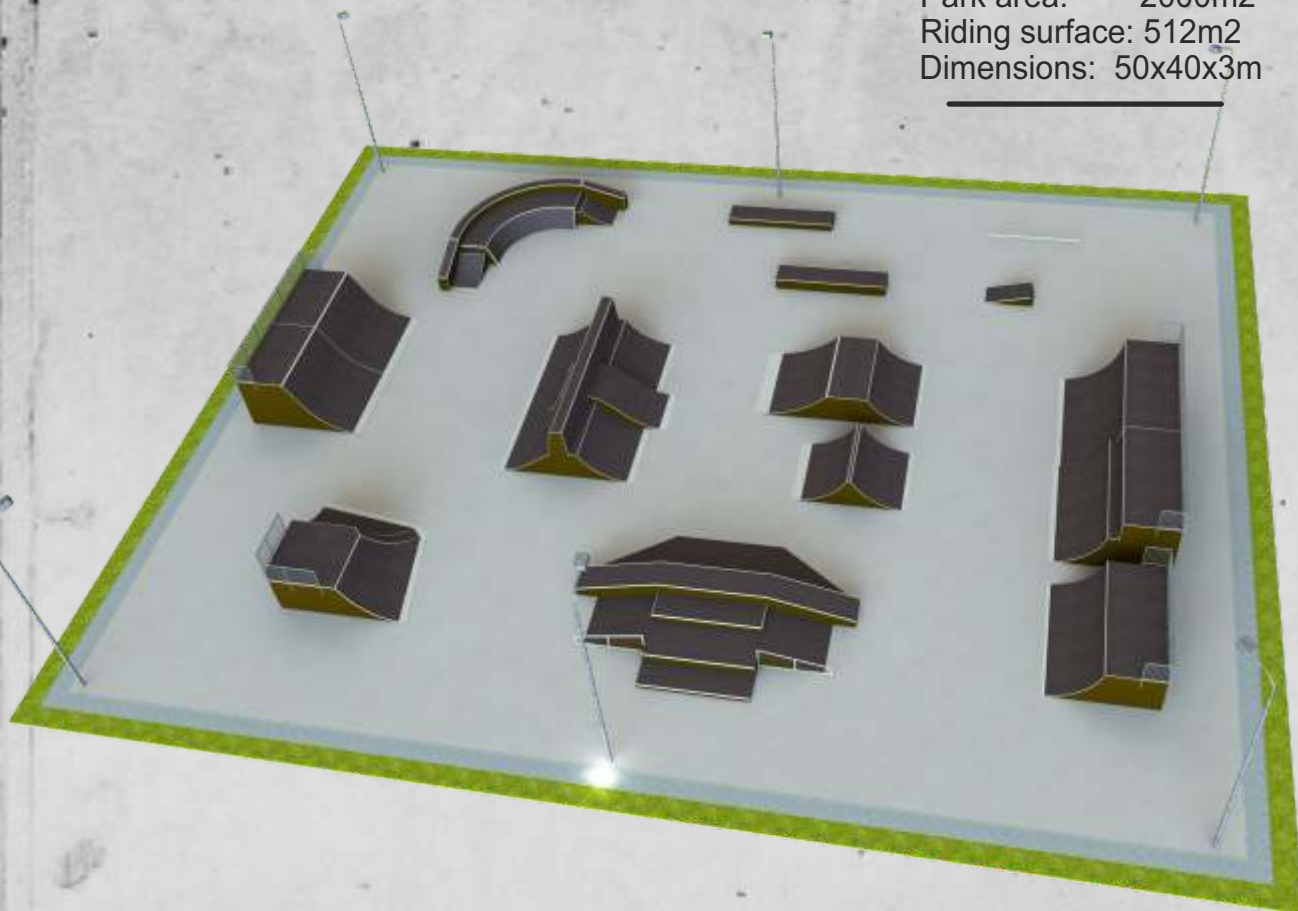



ooo



ooo



ooo



ooo

B 230

Park area: 940m²

Riding surface: 580m²

Dimensions: 47x20x3.5m

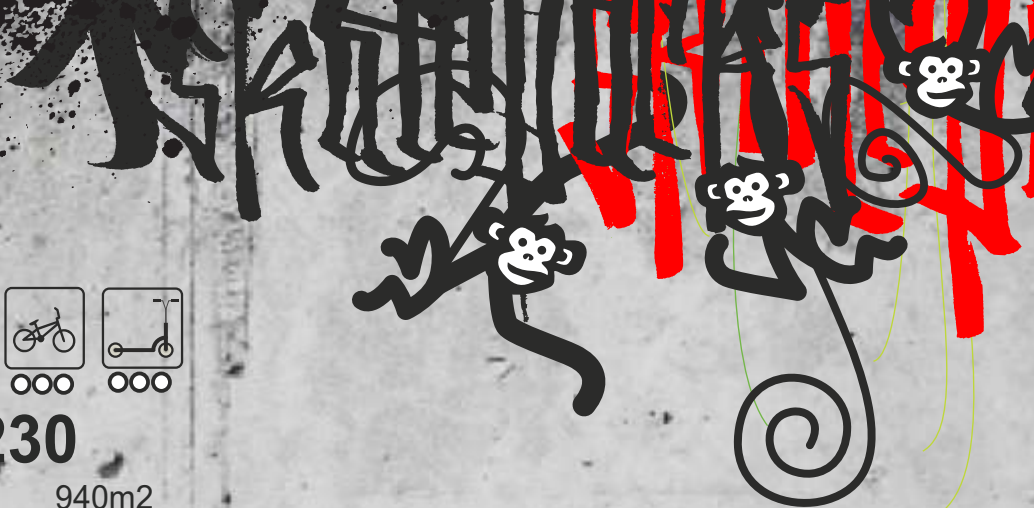

SKATEPARK



ooo



oo



oo



ooo

B 235

Park area: 990m²

Riding surface: 360m²

Dimensions: 33x30x3m





ooo



ooo



ooo



ooo

B 242

Park area: 1800m²

Riding surface: 760m²

Dimensions: 62x43x3.5m

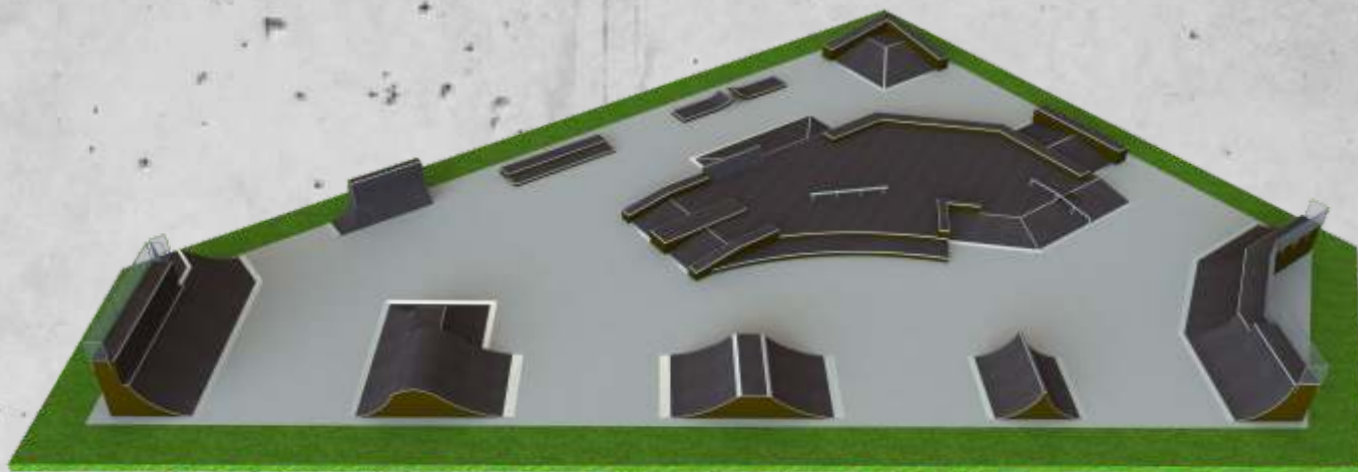

Plaza



ooo



oo



o



ooo

PLZ 010 B

Park area: 300m²

Riding surface: 49m²

Dimensions: 25x12x0.6m

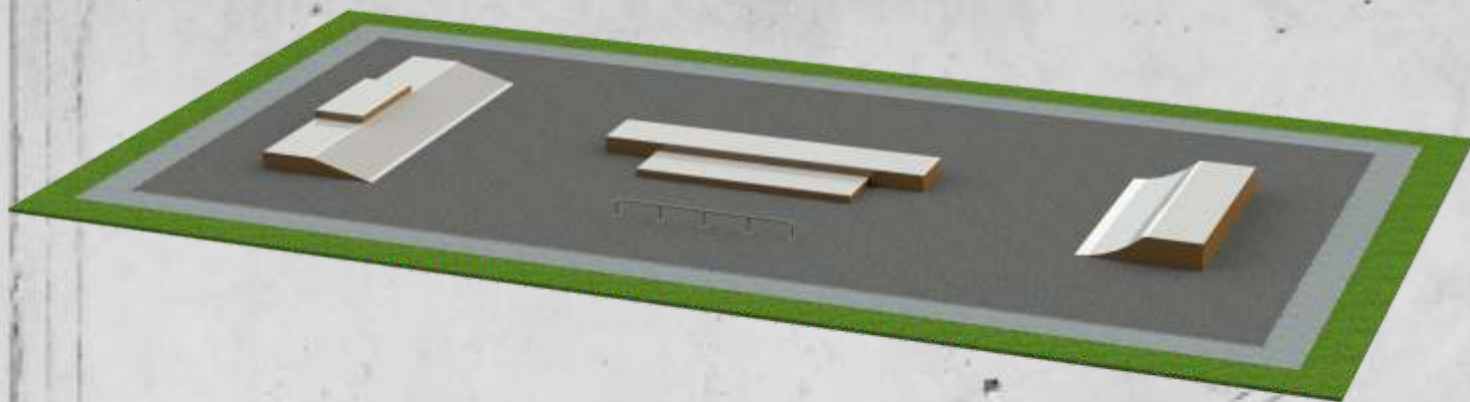



ooo



oo



oo



ooo

PLZ 020 B

Park area: 300m²

Riding surface: 49m²

Dimensions: 25x12x0.8m

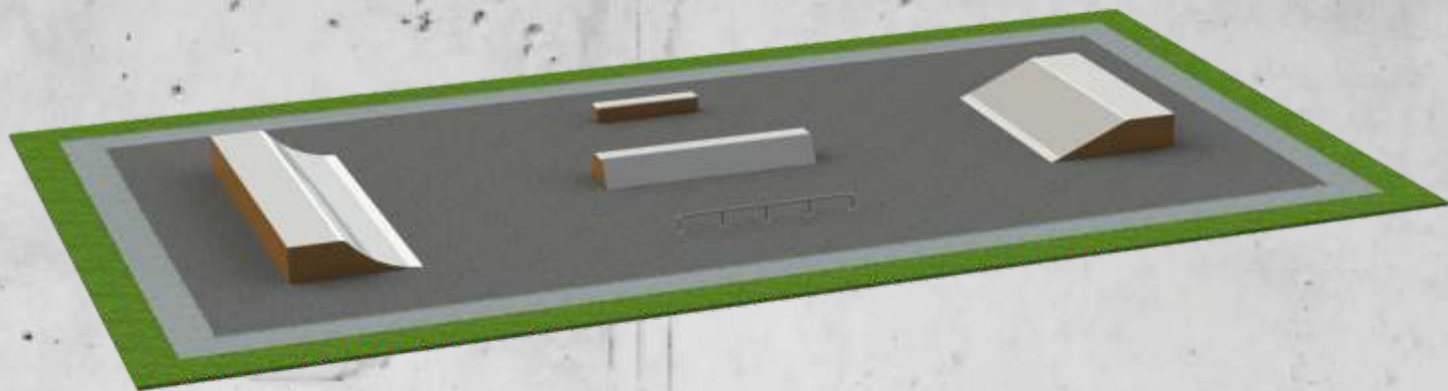

SKATEPARK



ooo



o



o



ooo

PLZ 030 B

Park area: 364m²

Riding surface: 58m²

Dimensions: 26x14x0.6m

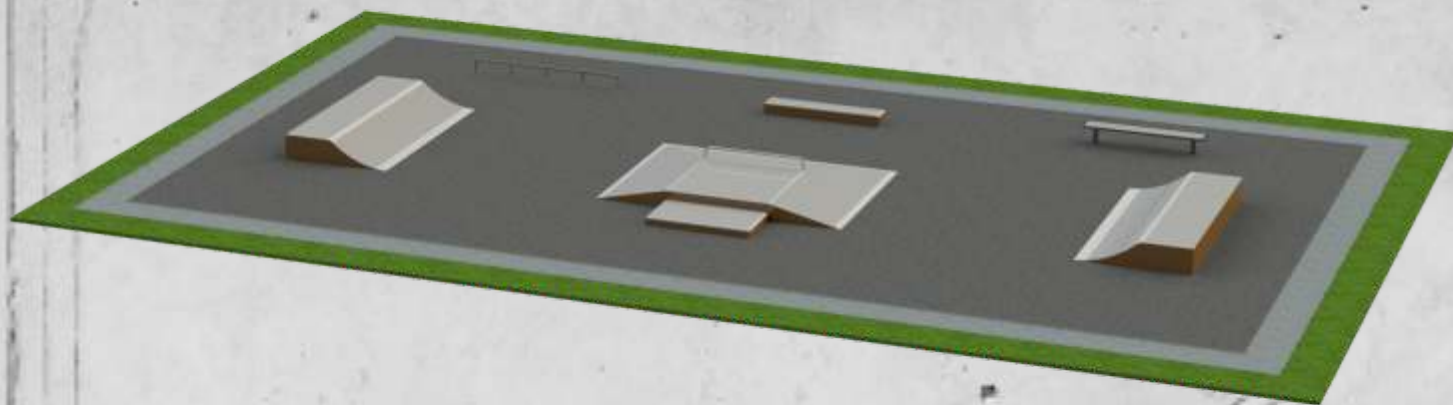



PLZ 040 B

Park area: 364m²

Riding surface: 78m²

Dimensions: 26x14x1.1m

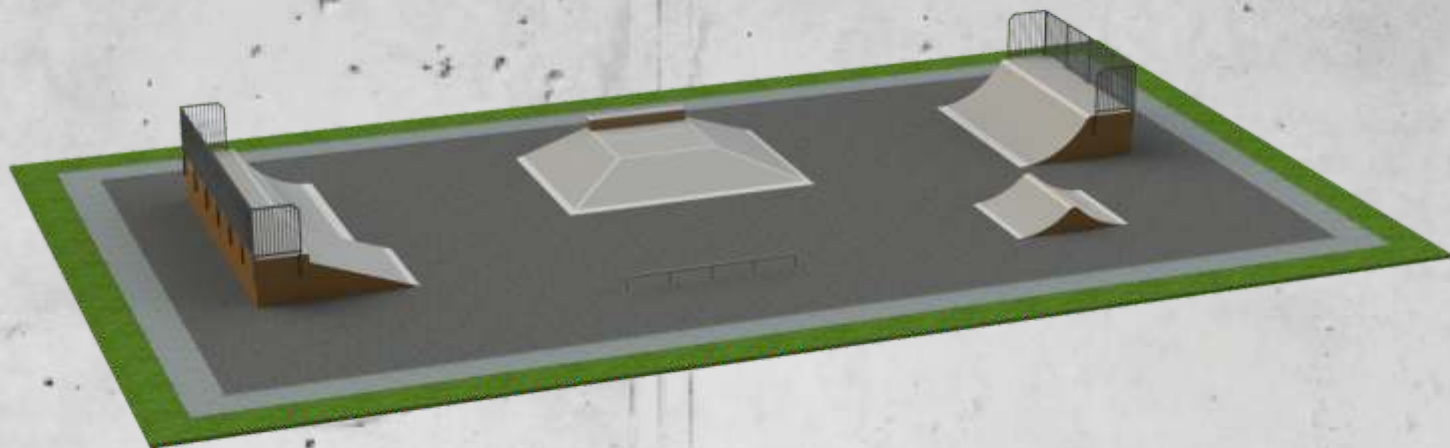

SKATEPARK



ooo



oo



o



ooo

PLZ 050 B

Park area: 325m²

Riding surface: 42m²

Dimensions: 25x13x0.6m

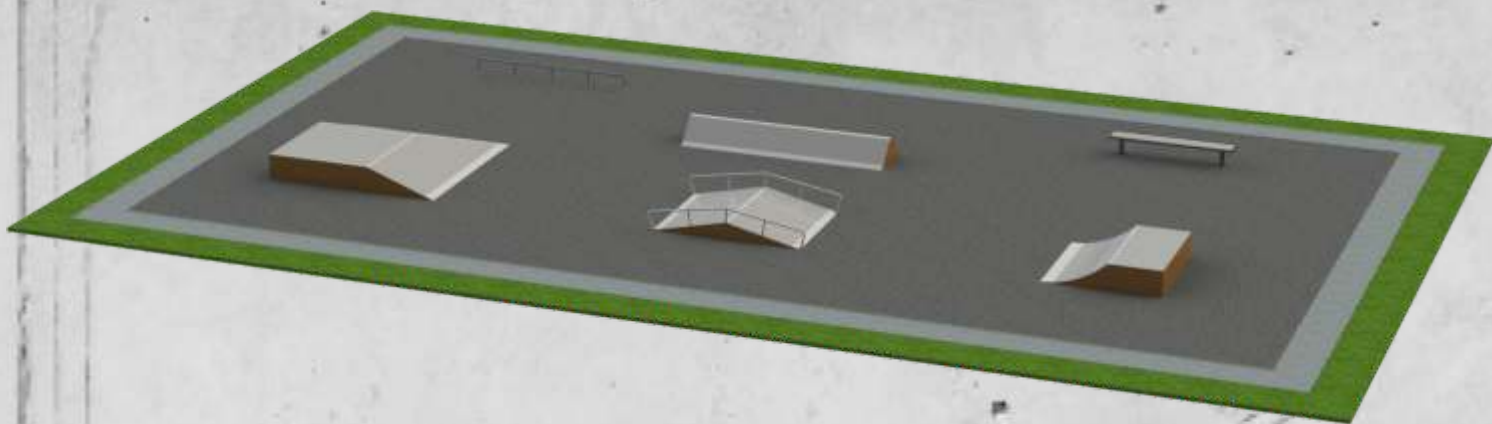



PLZ 060 B

Park area: 892m²
Riding surface: 160m²
Dimensions: 35x25.5x1.1m

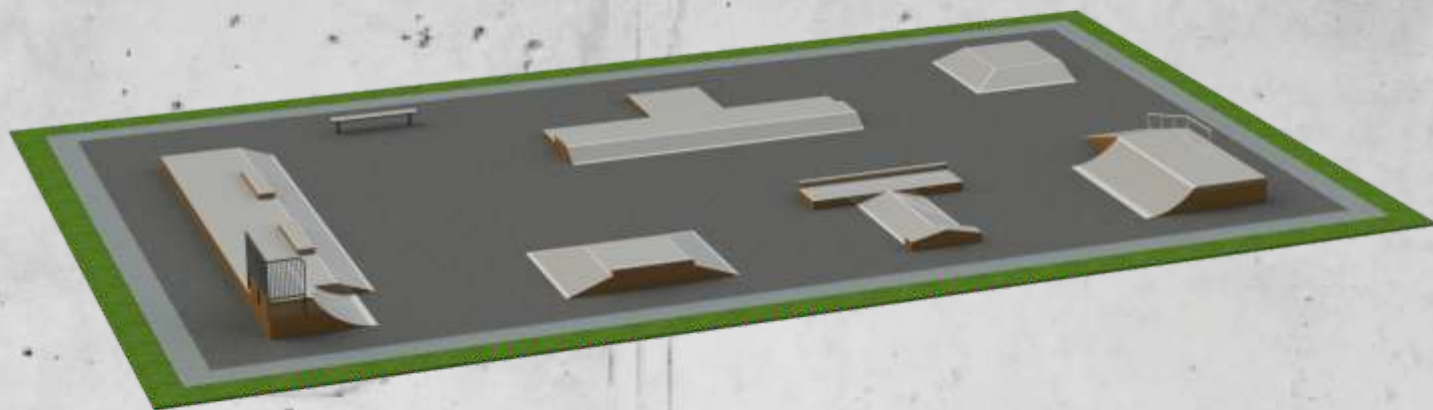

SKATEPARK





SKATEPARK





SKATEPARK





SKATEPARK





SKATEPARK





SKATEPARK

Base MONO SKATEPARKS

MONO skateparks have a special monolithic structure. They can be installed anywhere, even without an asphalt surface. Entire skatepark is built on special concrete pillars



The frame has a unique system providing strength and stability to the entire skatepark.



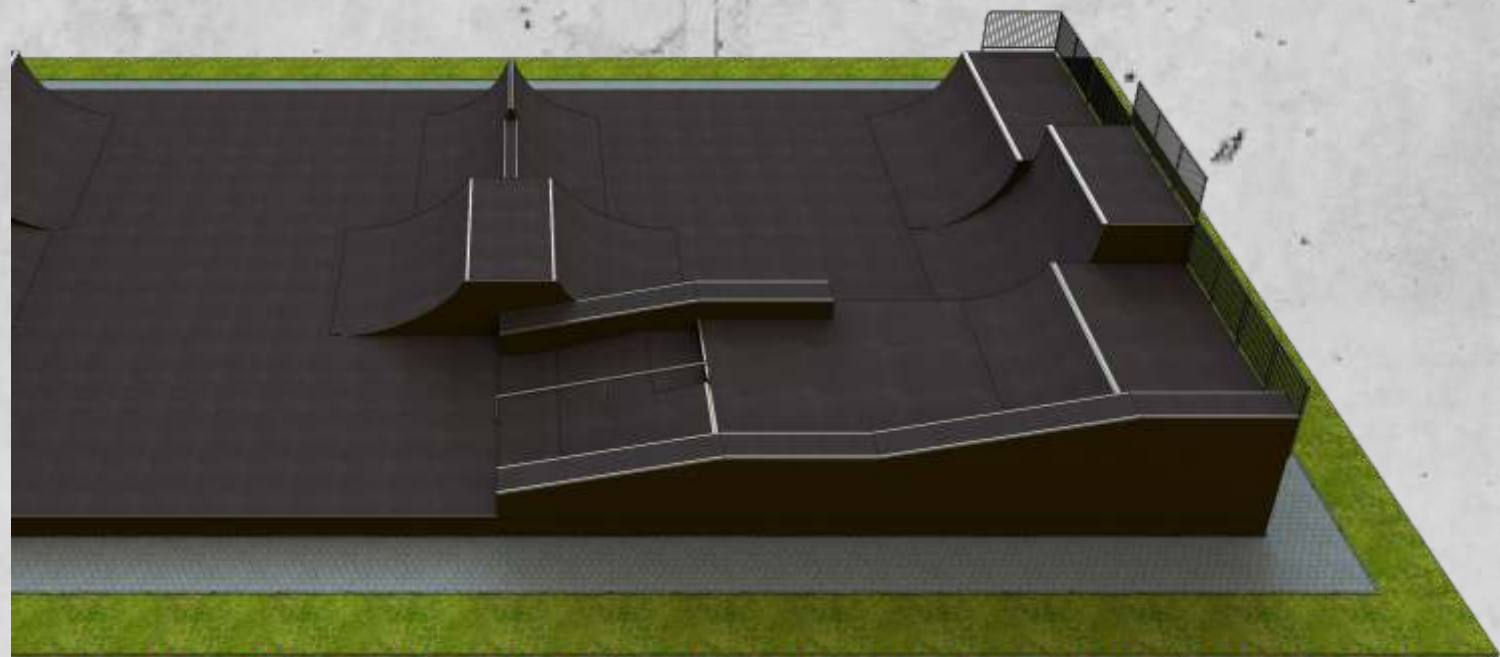

SKATEPARK



ooo



ooo



o



ooo

M 500

Riding surface: 203m²

Dimensions: 24x9x1.2m

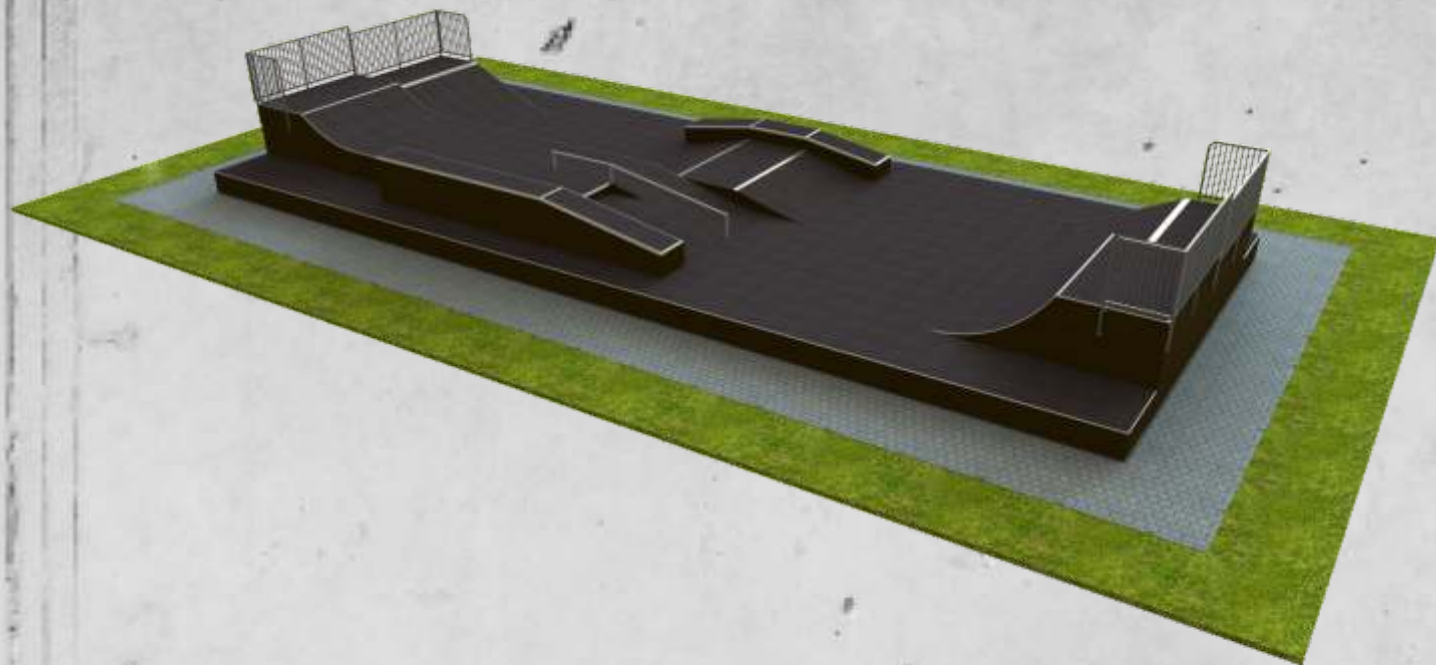



M 505

Riding surface: 239m²

Dimensions: 21x10.5x1.5m



SKATEPARK



oo



oo



oo



ooo

M 510

Riding surface: 230m²

Dimensions: 21x9x1.5m

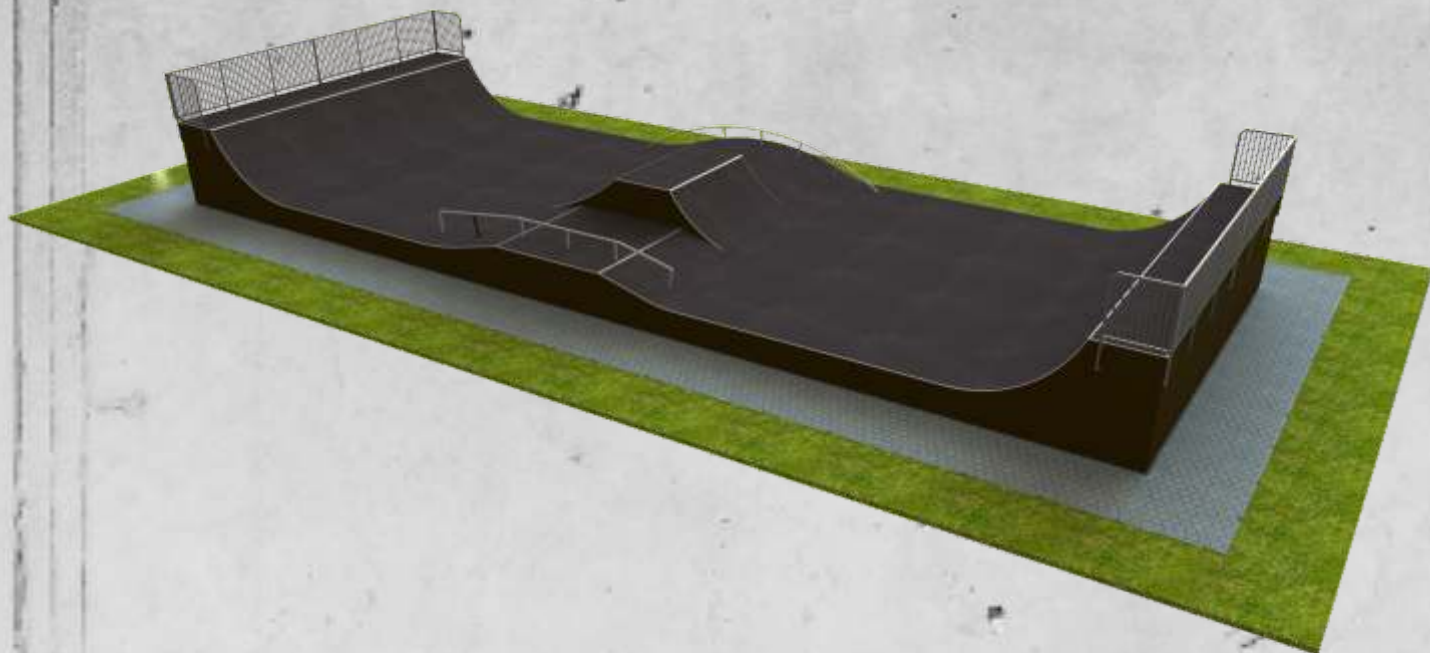



ooo



ooo



oo



ooo

M 515

Riding surface: 304m²

Dimensions: 30x10.5x2.5m

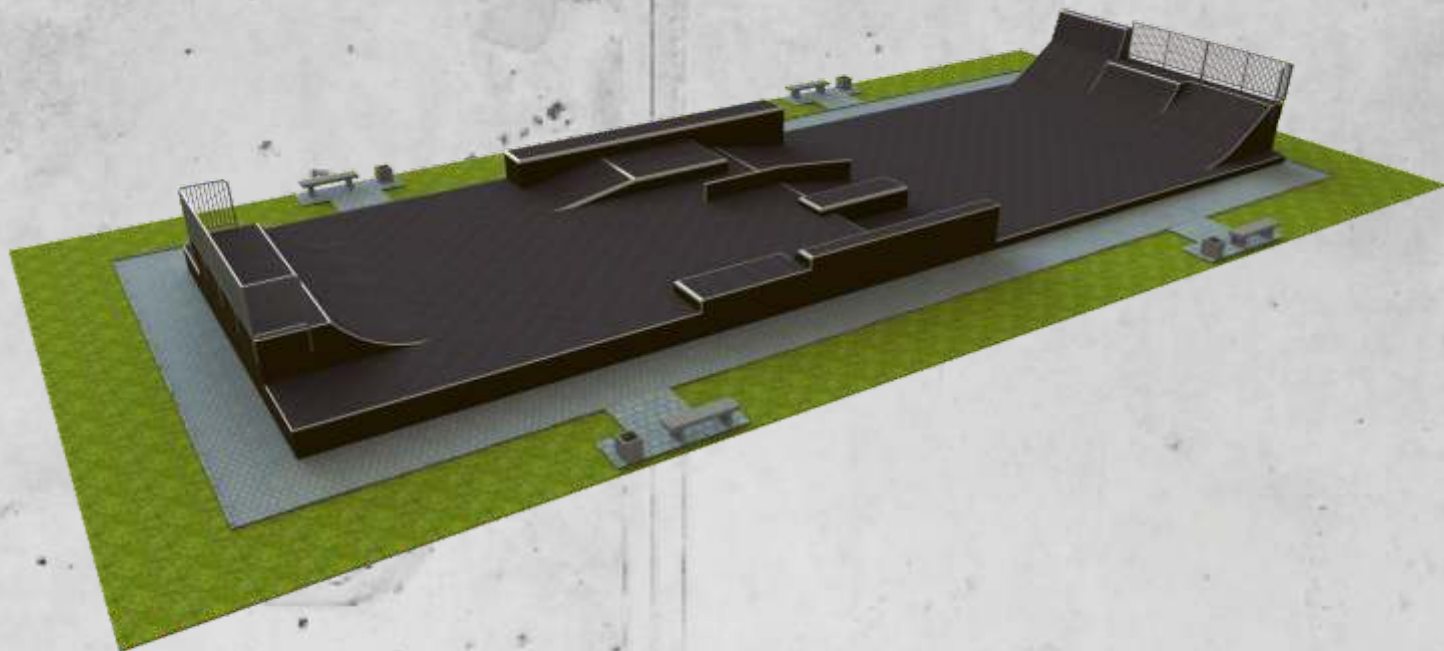

SKATEPARK



oo



oo



oo



ooo

M 520

Riding surface: 283m²

Dimensions: 30x9x2m

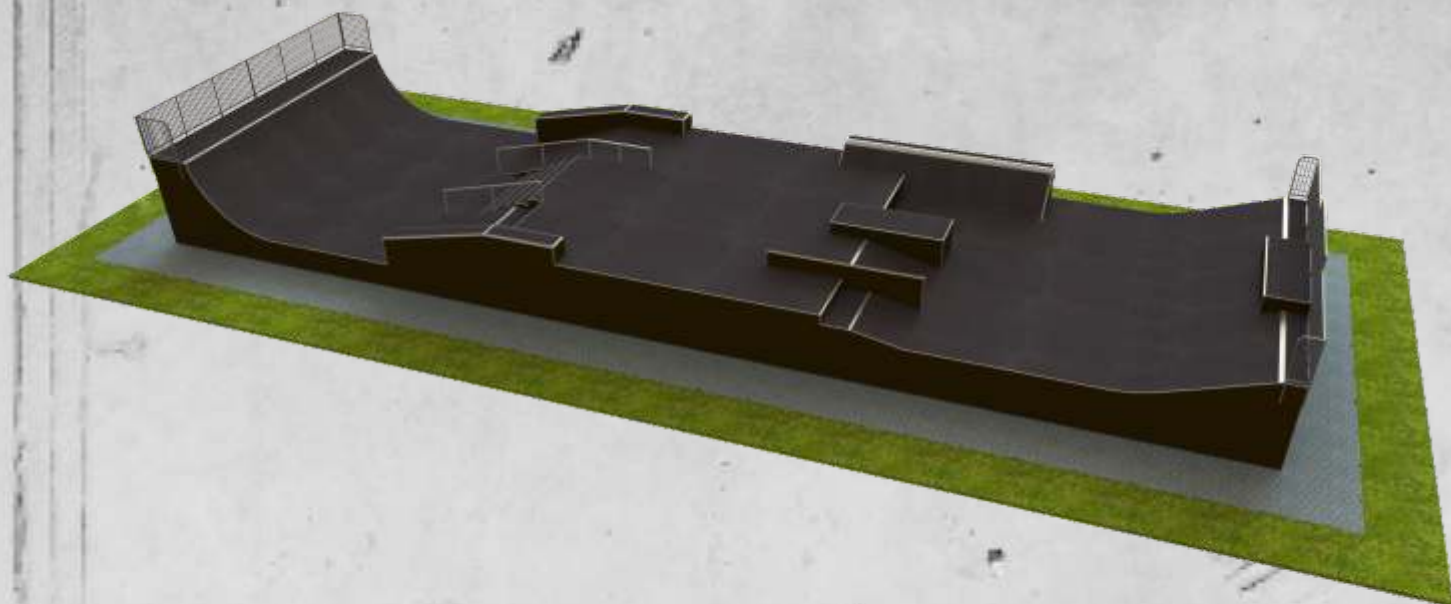



M 525

Riding surface: 290m²

Dimensions: 21x12x2.5m

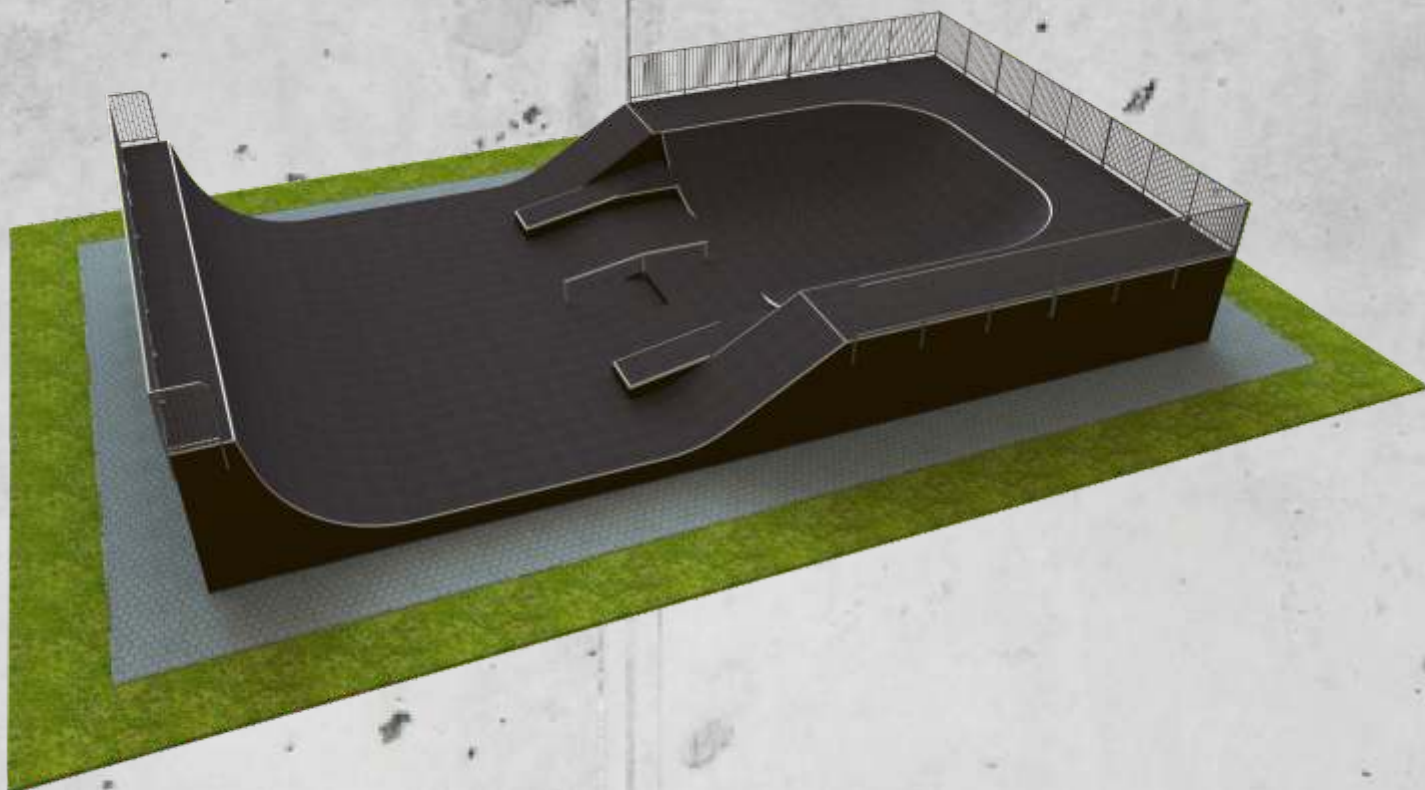

SKATEPARK



○



○○



○○○



○○○

M 530

Riding surface: 350m²

Dimensions: 24x12x4m

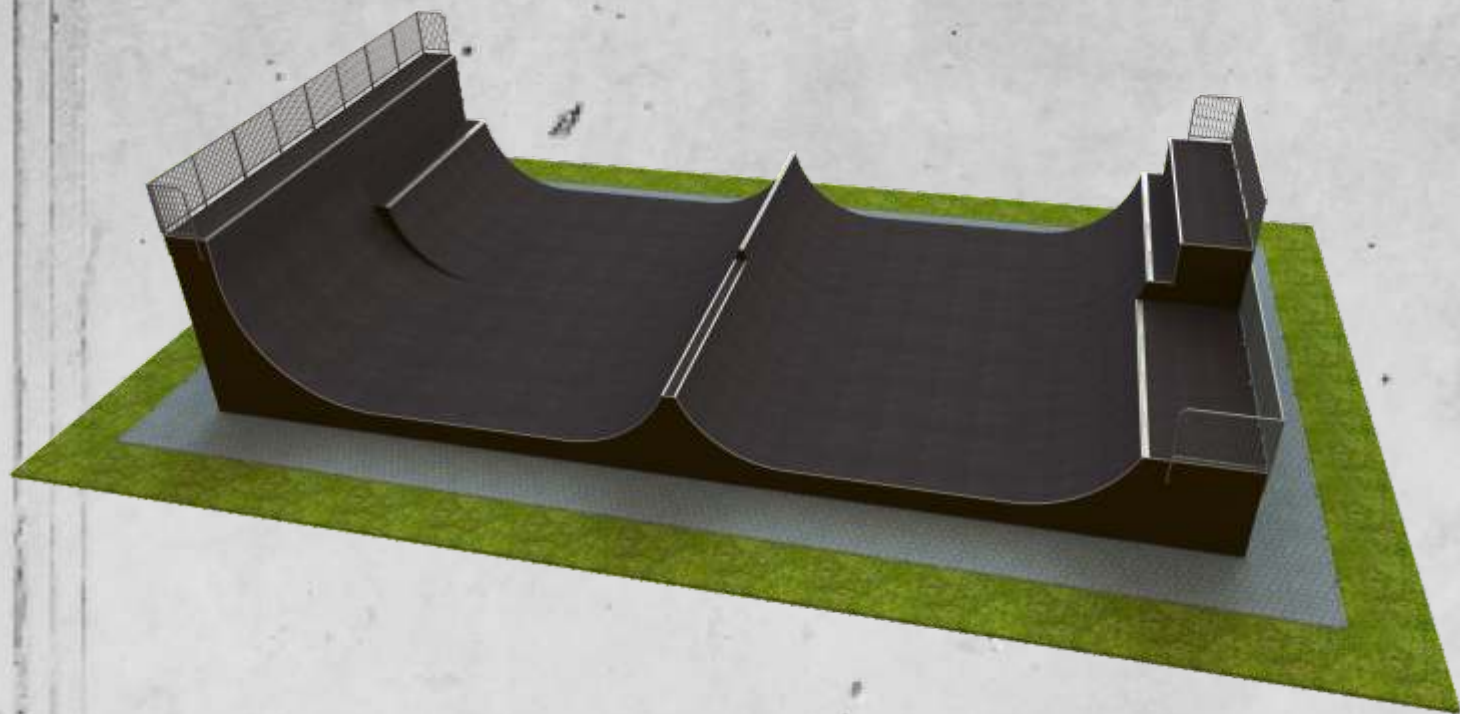



ooo



ooo



ooo



ooo

M 535

Riding surface: 538m²

Dimensions: 30x30x9x2m

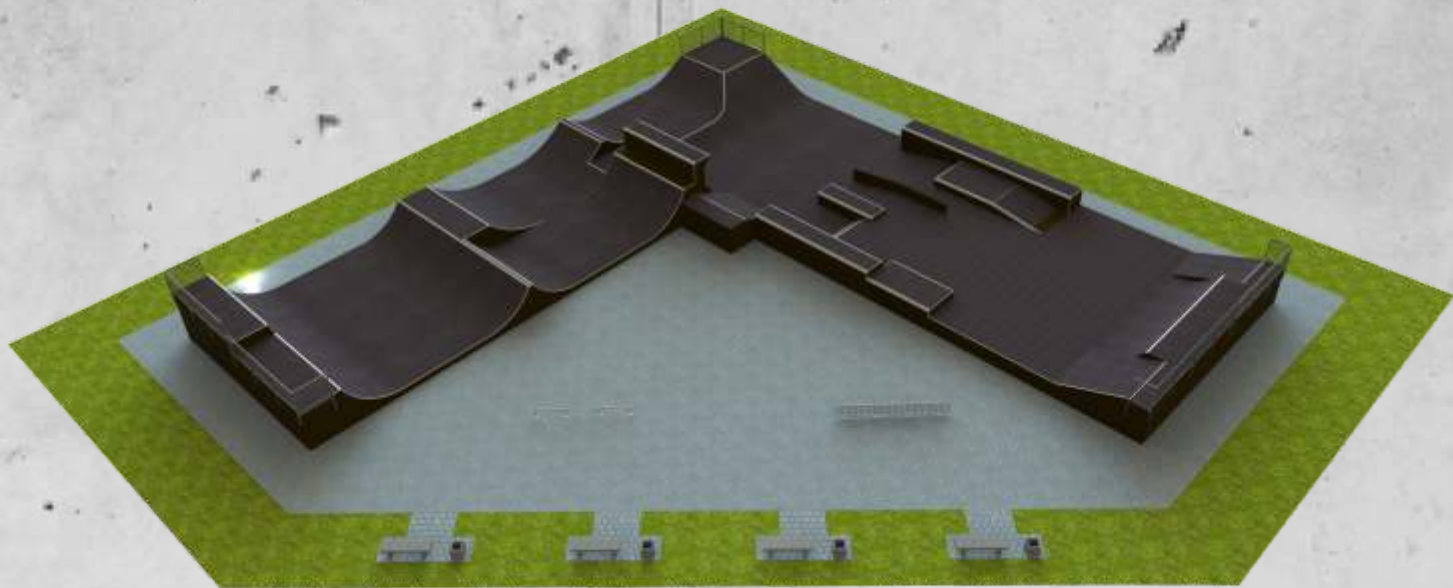

SKATEPARK



oo



ooo



oo



ooo

M 540

Riding surface: 572m²

Dimensions: 27x21x3m





M 545

Riding surface: 584m²

Dimensions: 30x18x3m

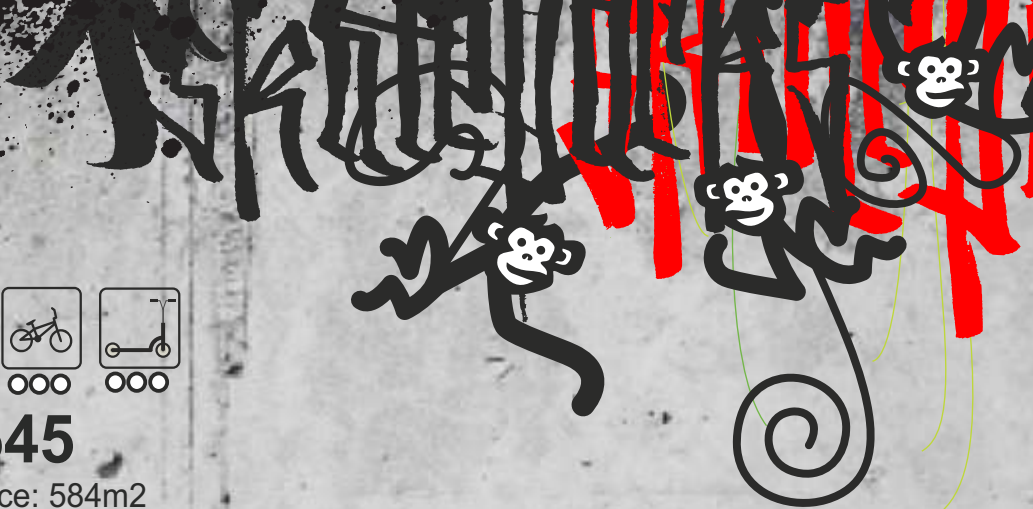
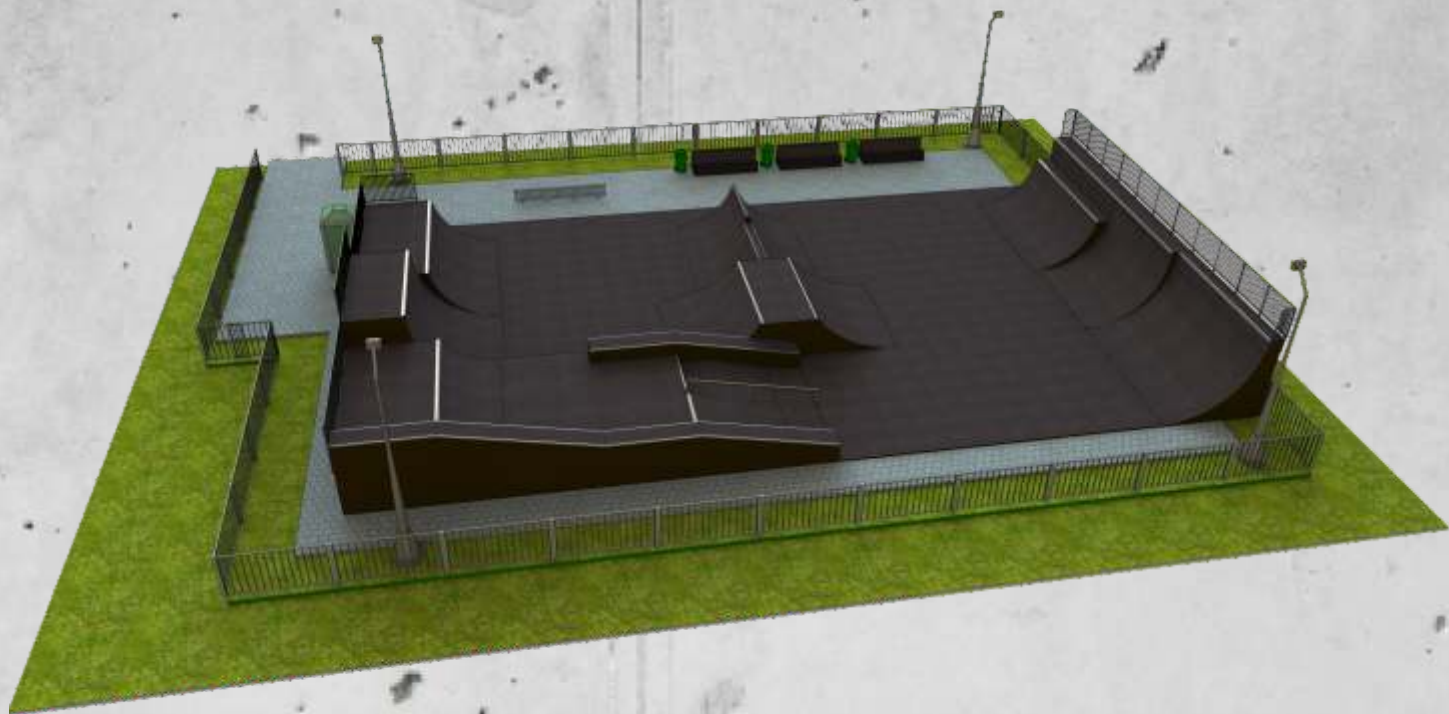

SKATEPARK



oo



ooo



ooo



ooo

M 550

Riding surface: 557m²

Dimensions: 24x21x3m





M 555

Riding surface: 933m²
Dimensions: 33x30x2m

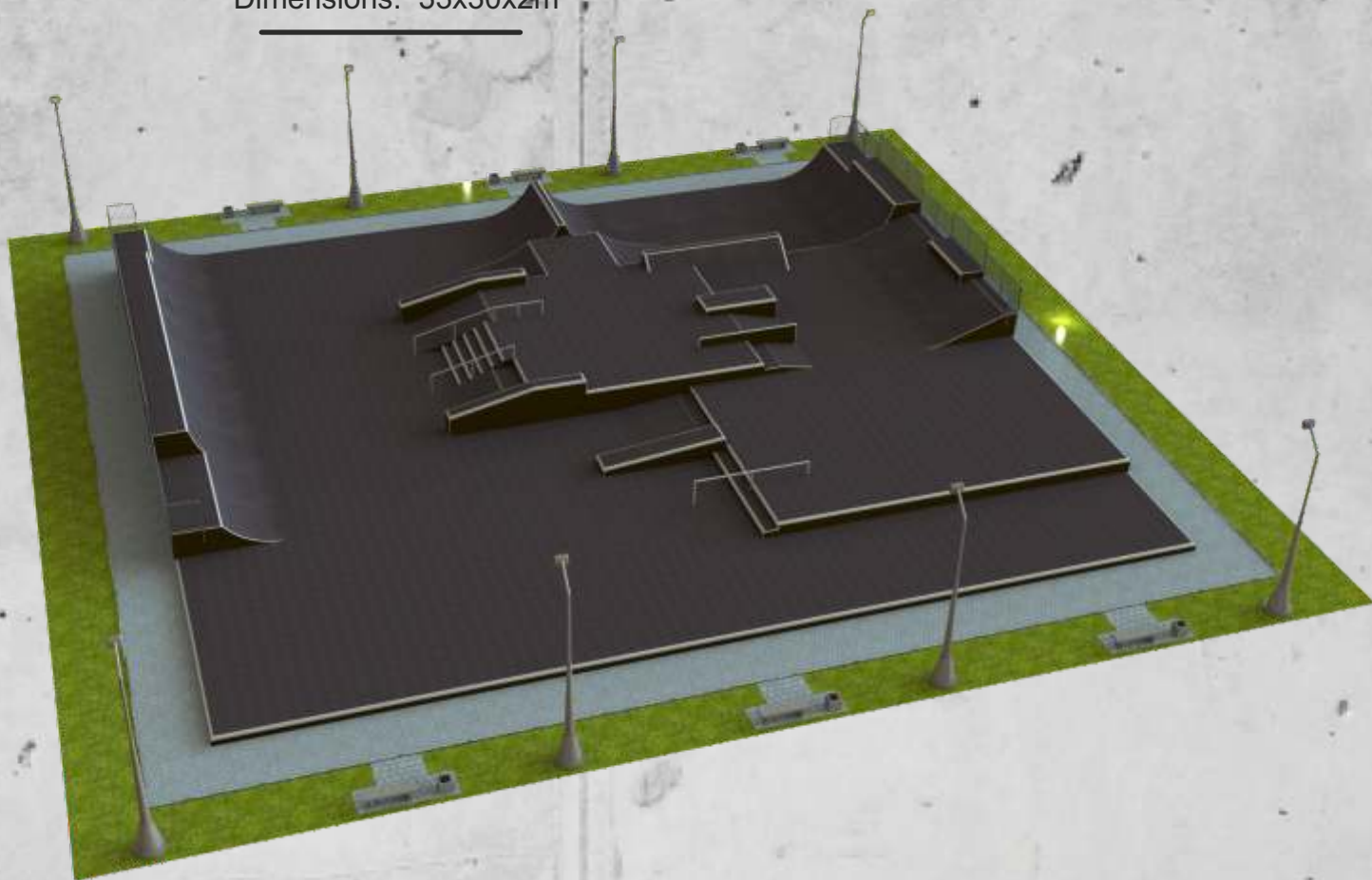

SKATEPARK

Half-pipes

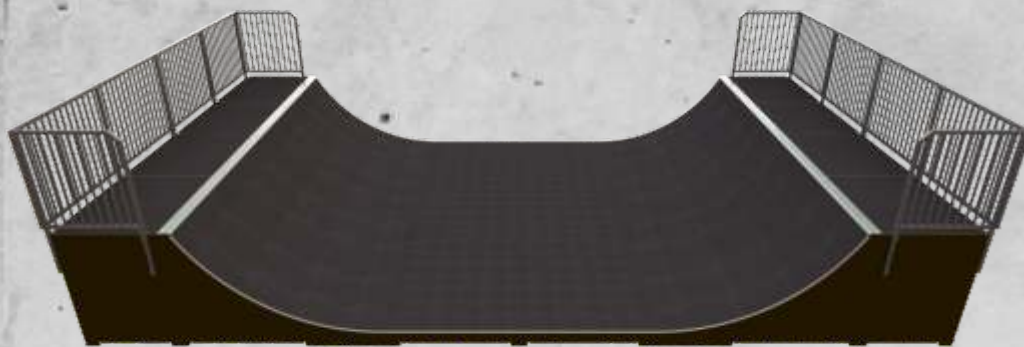

Code: **MR 01**
Height: 1.20-2.00m
Width: 3.0-9.00m



Code: **MR 02**
Height: 1.50-3.00m
Width: 4.5-9.00m

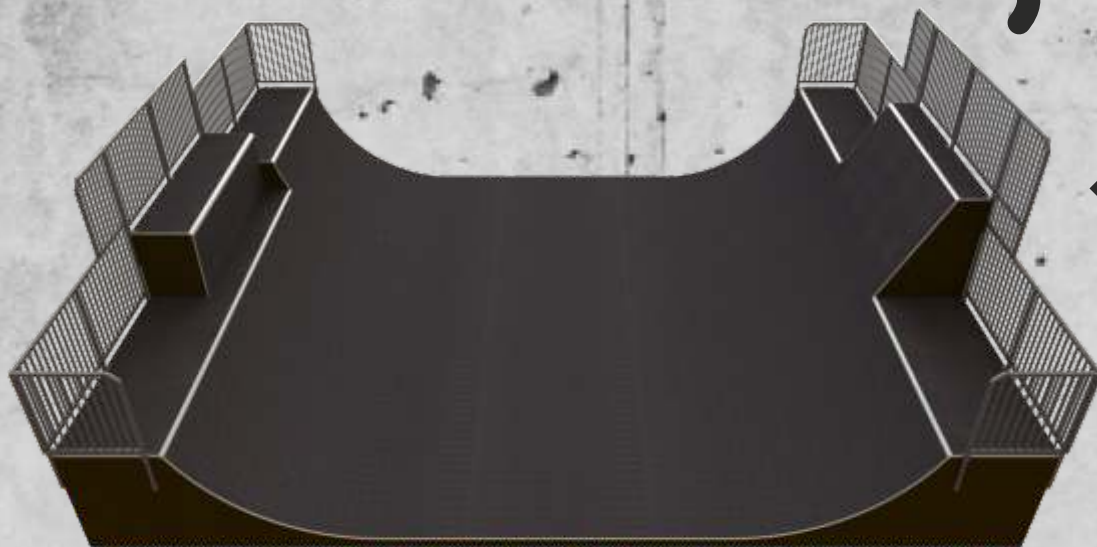

Code: MR 03
Height: 3.00m
Width: 9.00m
Length: 12.00m



Code: MR 04
Height: 4.00m
Width: 9.00m
Length: 15.00m

SKATEPARK

Separate constructions

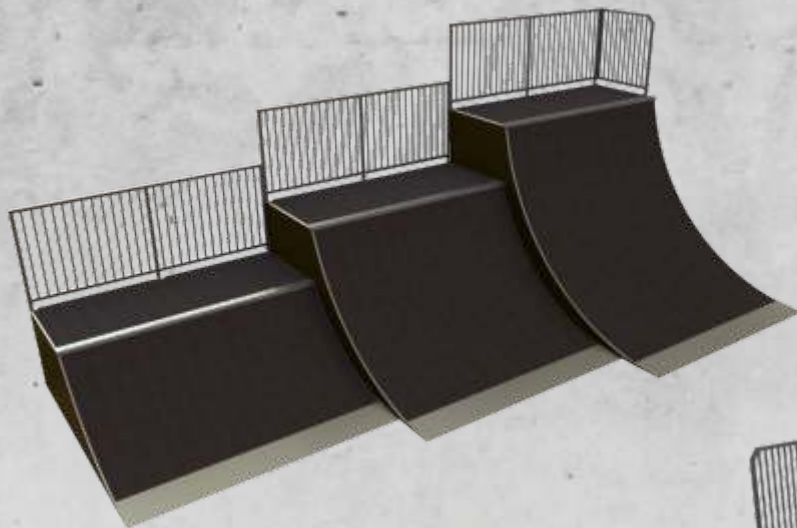

Quarterpipes
Code: QP

QP with subbox
Code: QP SB

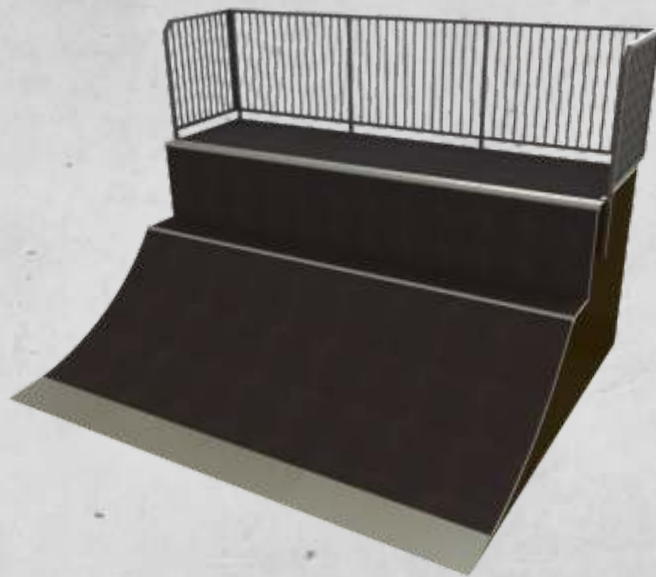

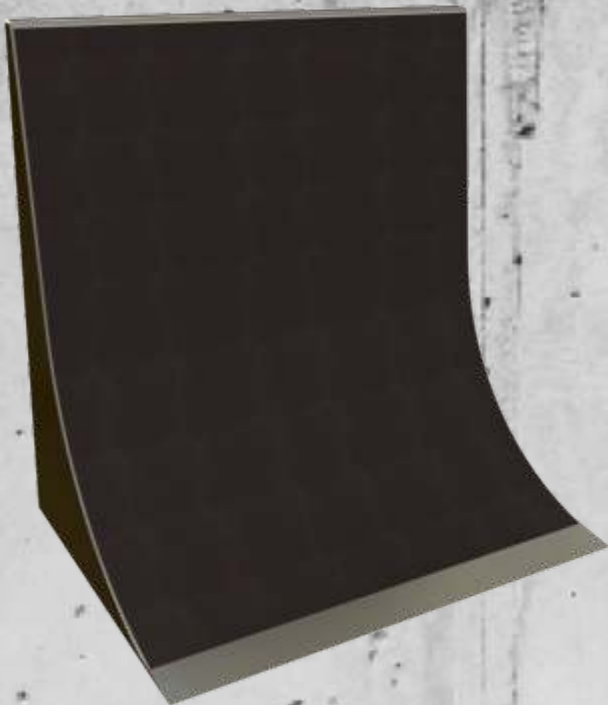

Vertical wallrides
Code: WL 01 A

Spines
Code: SPN

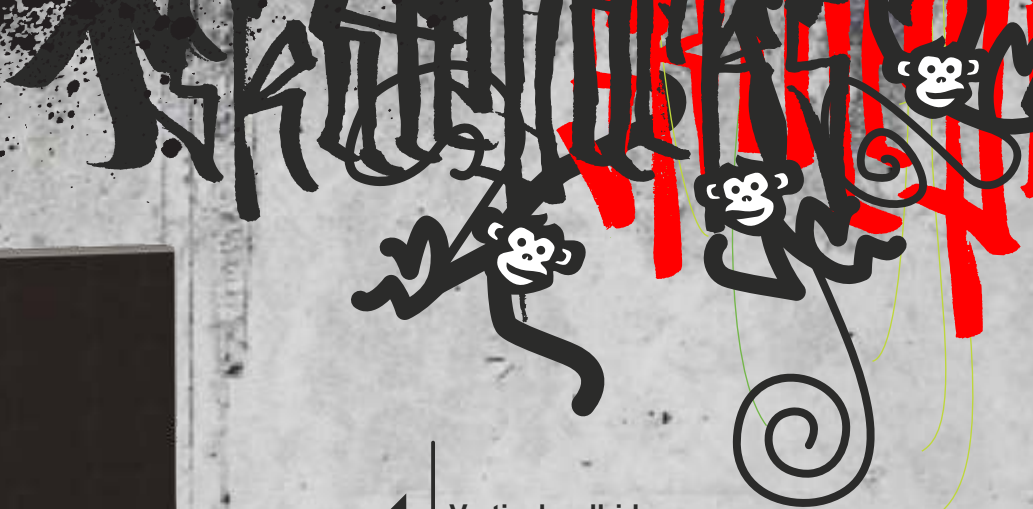
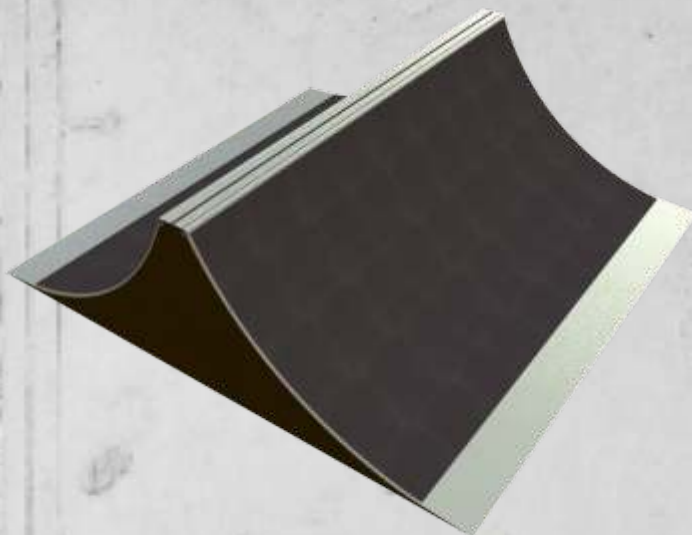

SKYMARK

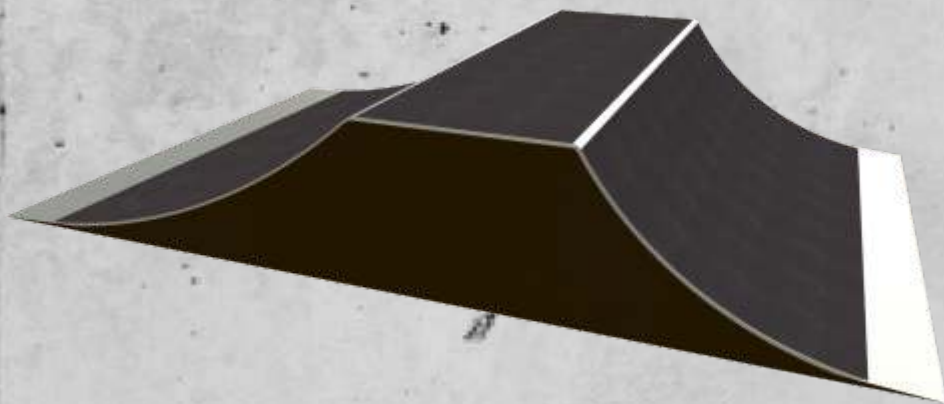

Flyboxes
Code: JBX 01

Flyboxes
Code: JBX 02

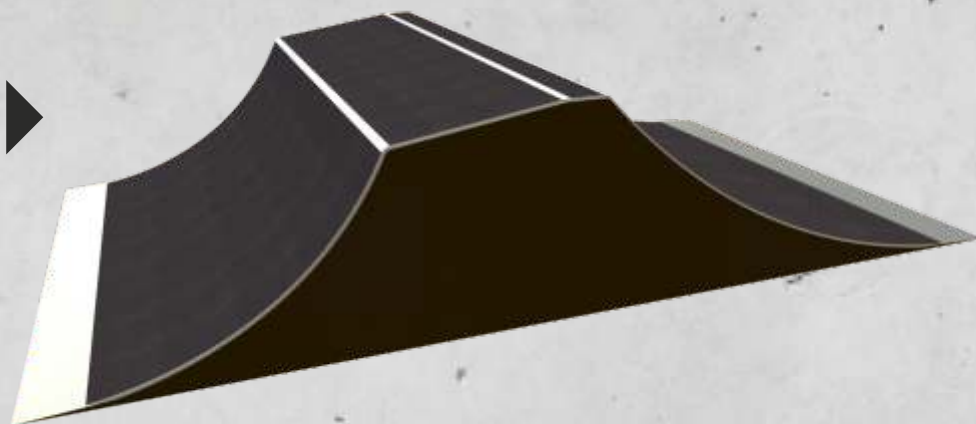

Banks
Code: BN

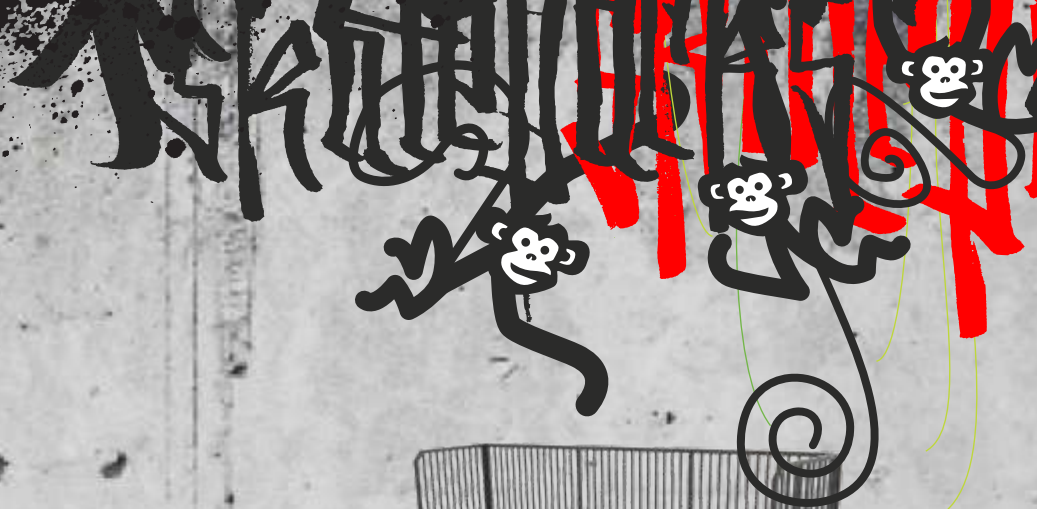
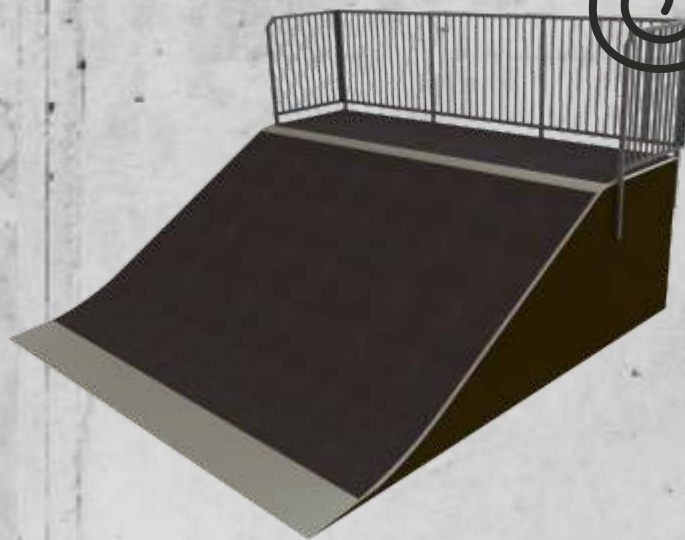

SKATEPARK

Funboxes

Code: SFB 01
Height: 1.00m
Width: 14.30m
Length: 8.00m

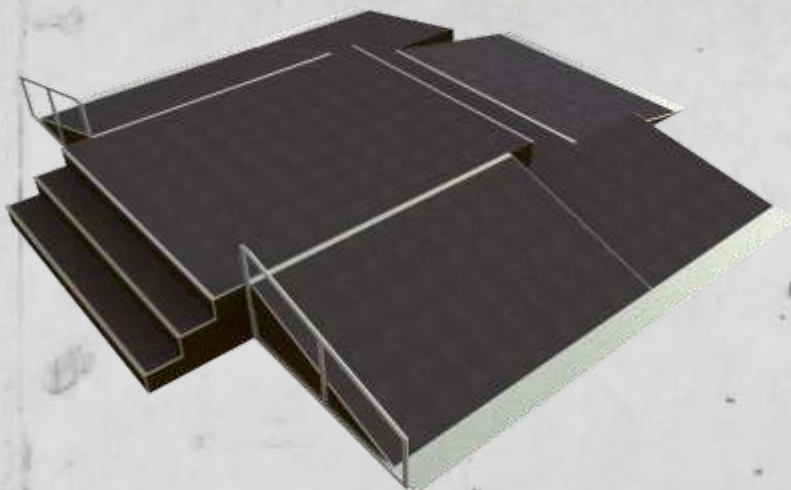
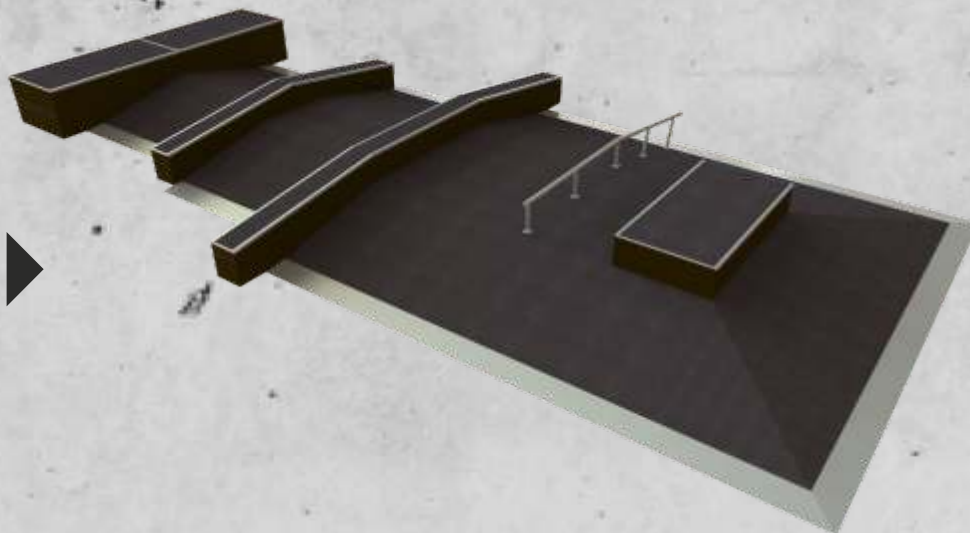

Code: SFB 02
Height: 0.90/1.40m
Width: 10.50m
Length: 9.40m

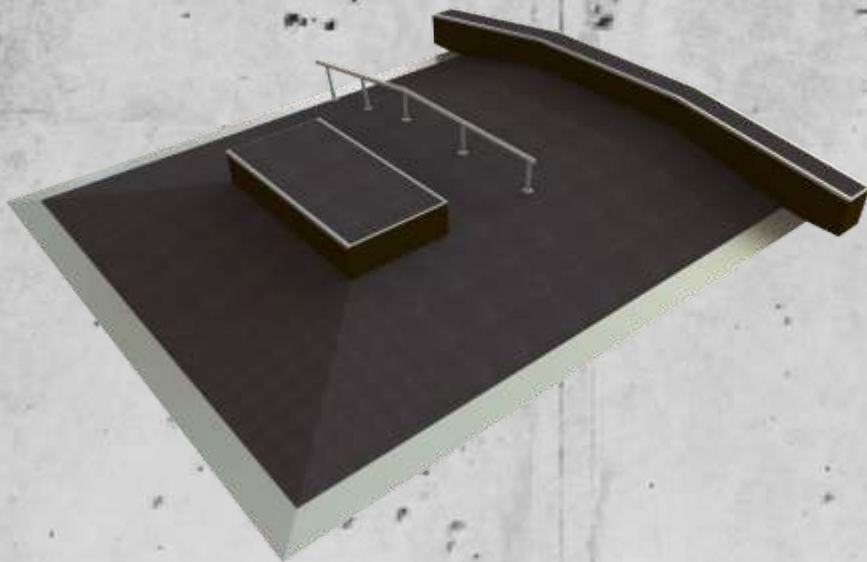

Code: SFB 03
Height: 1.00m
Width: 7.80m
Length: 7.40m

Code: SFB 04
Height: 1.00m
Width: 5.60m
Length: 6.90m

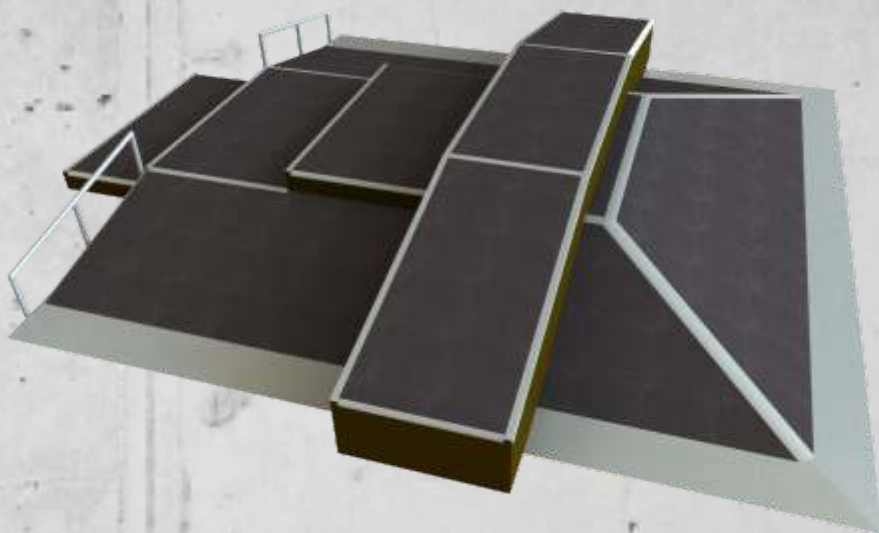

SKYMARK

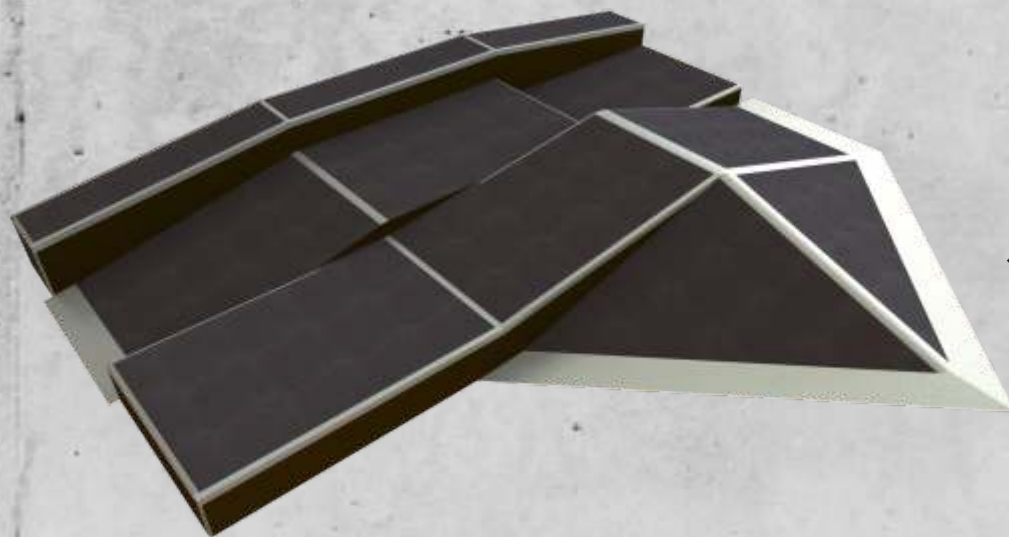

Code: SFB 05
Height: 0.80m
Width: 5.60m
Length: 6.90m

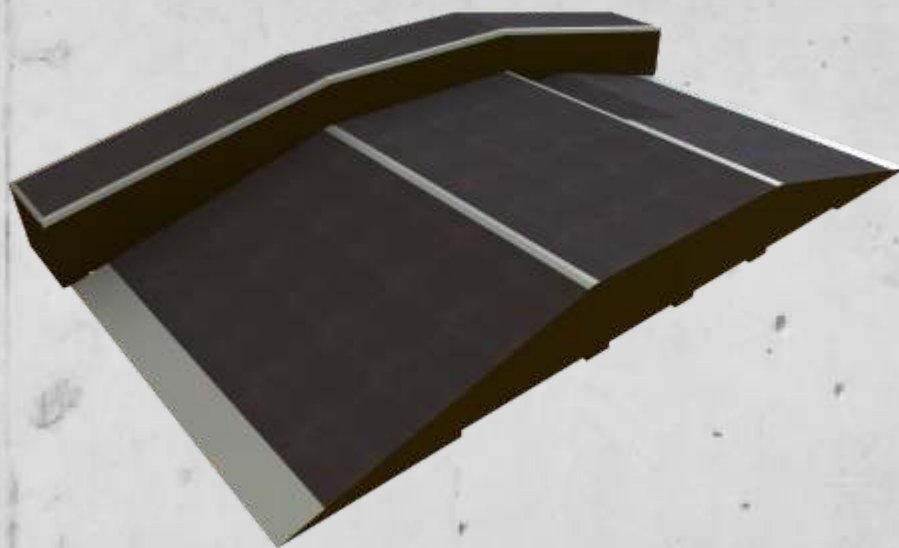

Code: SFB 06
Height: 1.00m
Width: 3.75m
Length: 6.60m

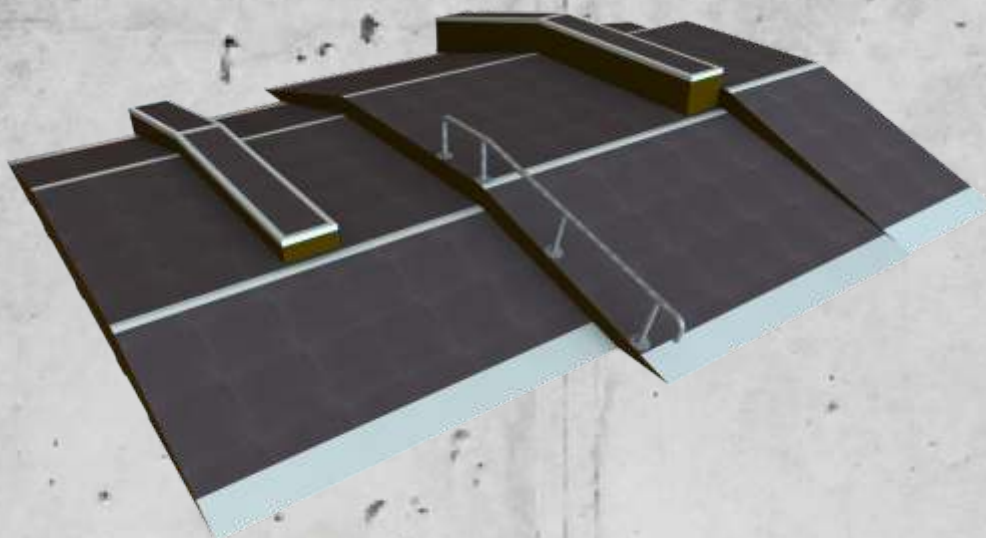

Code: SFB 07
Height: 1.00m
Width: 6.00m
Length: 7.00m

Code: SFB 08
Height: 1.00m
Width: 4.40m
Length: 6.50m

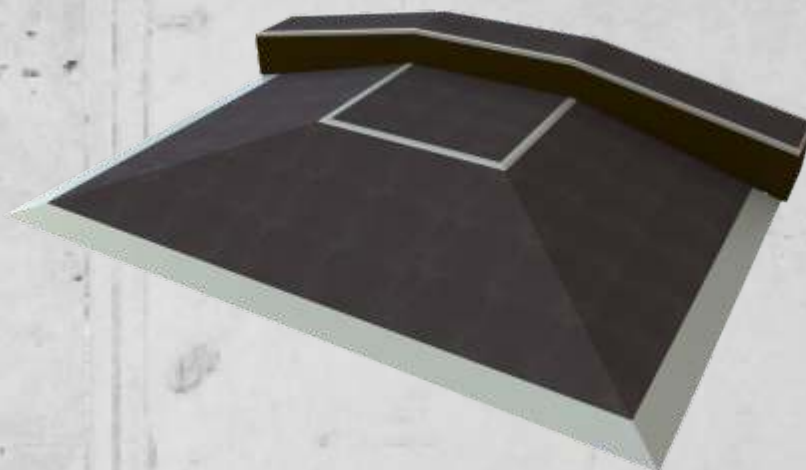

SKATEPARK

Slideboxes

Code: MBX 01

Height: 0.20-0.60m

Width: 1.22m

Length: 2.80m

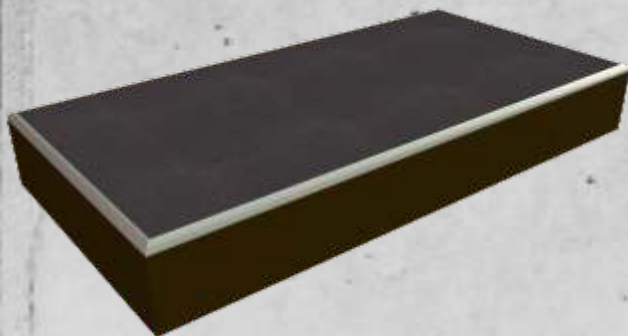

Code: MBX 02

Height: 0.60m

Width: 1.22m

Length: 4.80m

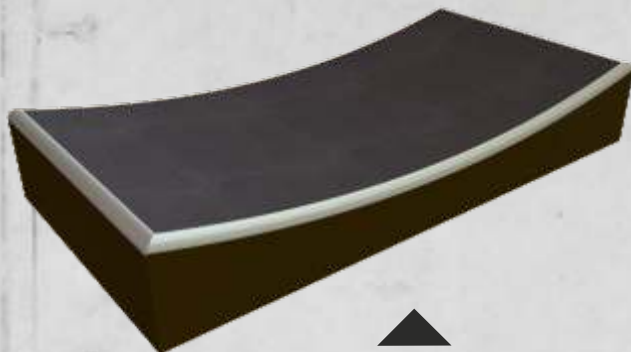
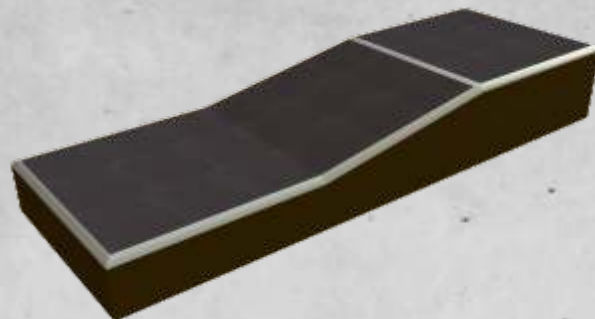

Code: MBX 03

Height: 0.50m

Width: 1.22m

Length: 2.80m

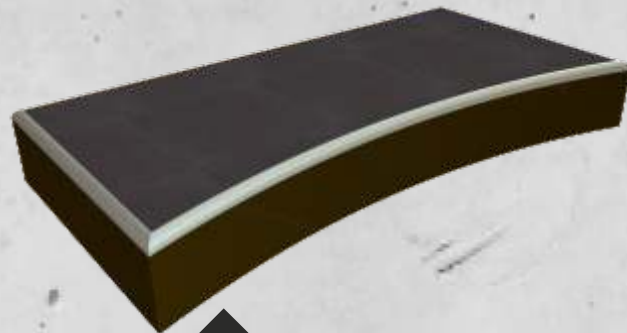

Code: MBX 04

Height: 0.35m

Width: 1.22m

Length: 2.80m

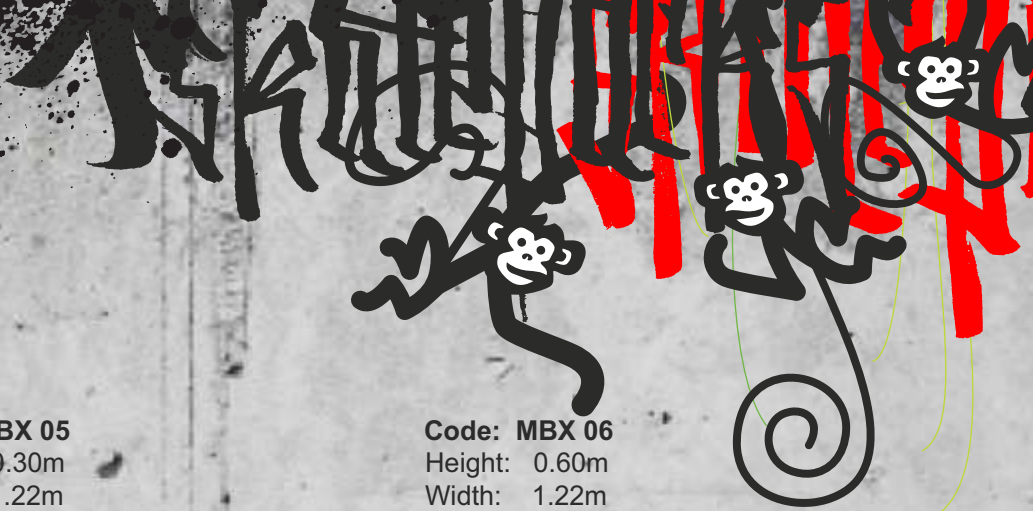

Code: MBX 05
Height: 0.30m
Width: 1.22m
Length: 2.80m



Code: MBX 06
Height: 0.60m
Width: 1.22m
Length: 2.88m

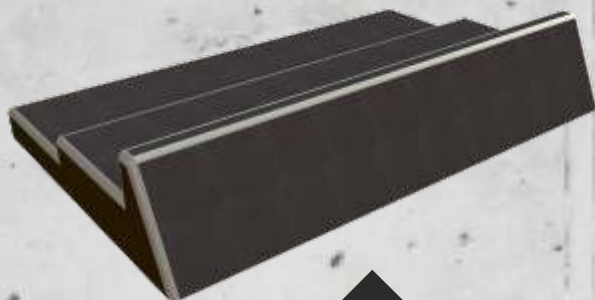
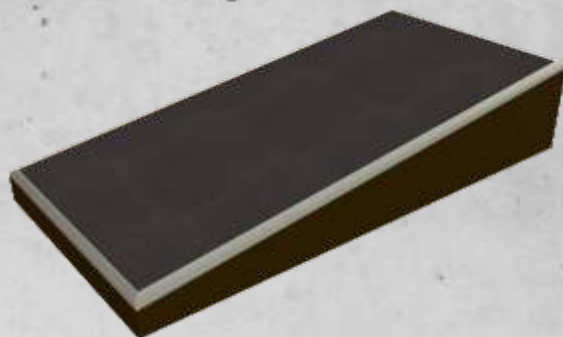

Code: MBX.07
Height: 0.90m
Width: 3.00m
Length: 2.80m



Code: MBX 08
Height: 0.90m
Width: 0.90m
Length: 2.80m



SKATEPARK

Kickers

Code: KICK 01

Height: 0.30m

Width: 1.22m

Length: 1.20m

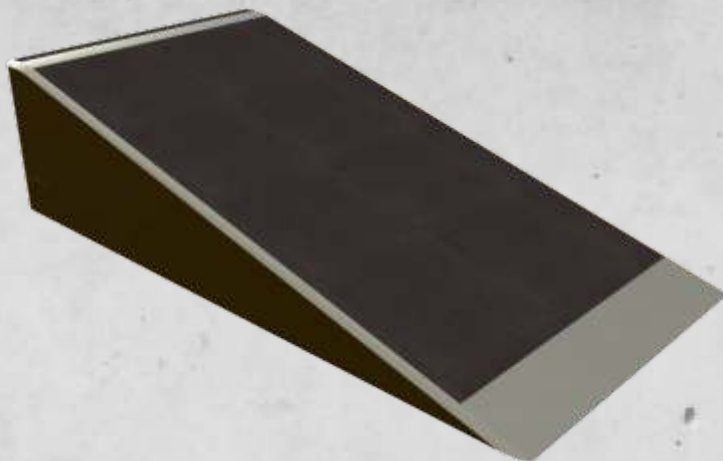
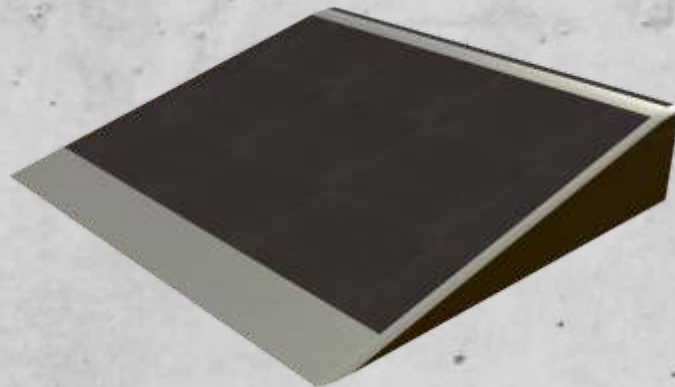

Code: KICK 02

Height: 0.50m

Width: 1.00m

Length: 1.90m



Slides

Code: RAIL 01

Height: 0.40m

Width: 0.06m

Length: 4.00-5.00m



Code: RAIL 02

Height: 0.40-0.60m

Width: 0.06m

Length: 5.50m

SKATEPARK



SKATEPARK



SKIVMARK



Forhandler Norge

ArC

Arealconsut AS
Fæsteråsen 63
5184 Olsvik -Bergen
Pb. 533 Olsvik
5884 Bergen
Tlf.(0047)55 59 16 00
e-post:
post@arealconsult.no
www.arealconsult.no